

## ADDENDUM No. 2

---

PROJECT: 20241201 - SB000B - MULTI-BUILDING - Campus Pavement Maintenance (Parkside, CRHC, Northside, SAC, IUPD)  
CLIENT: Indiana University South Bend  
ISSUE DATE: April 23, 2025

The following changes shall be included in the Plans and Specifications for the above referenced project, as prepared by Wightman & Associates, Inc. dated **April 2025**. This Addendum shall be deemed a part of the Contract Documents, and to the extent that the provisions of the other Contract Documents are in conflict herewith, this Addendum shall control.

### CLARIFICATIONS:

1. Question during prebid: Is Crushed concrete acceptable for compacted aggregate 53? Yes this material will be acceptable as long as it meets gradation.
2. All signs within limits of new pavement in the large lot shall be installed per the detail on the plans with the concrete foundation. Please note that there must be at least one sign per ADA stall, which is more than existing by approximately 2 signs.
3. The lot adjacent to the Student Activities Center, north of the Northside North Employee lot for reconstruction, will need to be accessible during the project. Coordination will be required with IUSB staff on phasing of the middle entrance to the lots during construction operations.

### SPECIFICATIONS:

1. Construction Fence detail was unintentionally omitted from the plans and specs and is included in this addendum.
2. An item for removal and replacement of existing curb and gutter at the direction of the IUSB staff or engineer in the field has been added to the list for unit price items on the bid form. It is anticipated that this is the straight curb per the detail on the plans.

#### ***a. Removal and Replacement of Curb, Ft***

### DOCUMENTS:

1. Construction fence detail is attached.
2. Updated Bid Form is attached for use with updated unit pricing.



FRONT

- CRITERIA:
- ≥ \$2M AWARDED CONSTRUCTION COST AS A DONOR SUPPORTED PROJECT: USE LETTERED FENCING WITH “PHILANTHROPY AT WORK”.
  - ≥ \$2M AWARDED CONSTRUCTION COST AS A NON-DONOR SUPPORTED PROJECT: USE LETTERED FENCING
  - < \$2M AWARDED CONSTRUCTION COST PROJECT: ONLY SOLID RED (#201) FENCING (NO LETTERING OR LOGOS).

- NOTES:
1. ALL LETTERING & LOGO TO BE CENTERED VERTICALLY ON SCREEN FABRIC
  2. PROVIDE HALF MOON VENTS 4’ O.C. - MIN TWO ROWS VERTICALLY ABOVE AND BELOW LETTERING
  3. SCREEN TO BE MINIMUM 80% PRIVACY, KNITTED HDPE UV POLYETHYLENE OR PVC CONSTRUCTION
  4. FONTS AND IU LOGO MUST BE PER IU BRAND GUIDELINES/STANDARDS

INDIANA UNIVERSITY  
CAPITAL PROJECTS  
CONSTRUCTION FENCING SCREEN  
STYLE GUIDE 01/03/2024

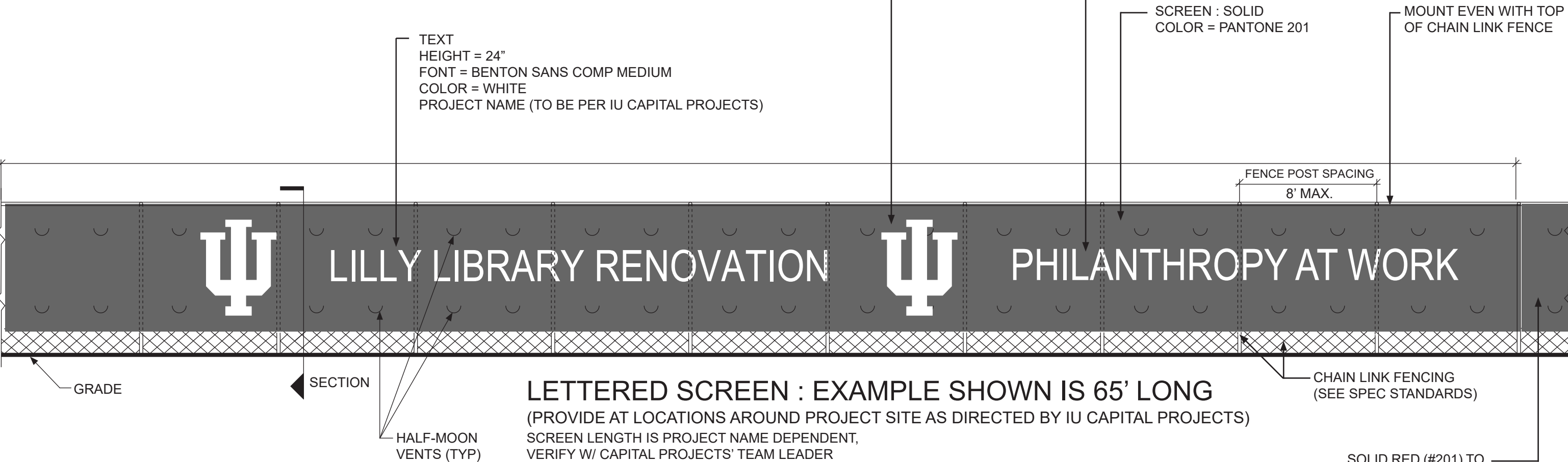

SECTION

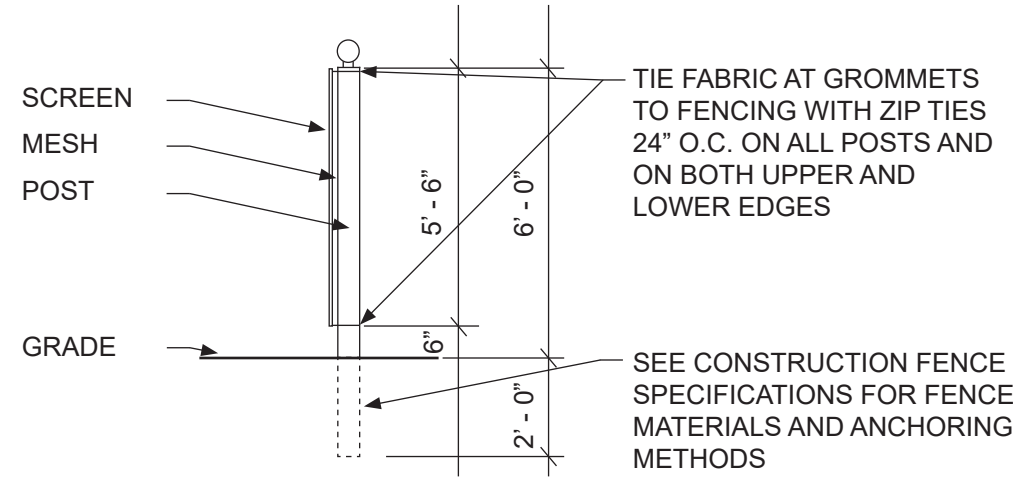

CONTACT INFORMATION

Logos and fonts are available via e-Builder in IU Standards/Signage Design within zIUResources  
VISIT [brand.iu.edu](http://brand.iu.edu) for additional downloads and information regarding brand, logo, font, and color standards  
PLEASE CONTACT IU SIGN SHOP for additional sign construction needs or questions at 812-856-0761

**BID FORM**

for

SB000B Multi-Building - Campus Pavement Maintenance  
(Parkside, CRHC, Northside, SAC, IUPD)  
Indiana University South Bend  
South Bend, Indiana  
IU 20241201

TO: The Trustees of Indiana University  
Bloomington, Indiana

**\*\*Submit bid online via [www.iuplanroom.com](http://www.iuplanroom.com)\*\***

FROM:

Bidder's Name \_\_\_\_\_  
Address \_\_\_\_\_  
City, State, Zip Code \_\_\_\_\_  
Phone Number \_\_\_\_\_ FAX Number \_\_\_\_\_

CONTACTS:

Bid / Contract Information: Name: \_\_\_\_\_  
Phone: \_\_\_\_\_ E-mail: \_\_\_\_\_  
Proposed Project Manager: Name: \_\_\_\_\_  
Phone: \_\_\_\_\_ E-mail: \_\_\_\_\_

Indicate if your firm is a certified minority-, women-, or veteran-owned business \_\_\_ Yes \_\_\_ No  
**If “Yes”, please attach a copy of certification**

FOR: **Unified Bid** to include General, Mechanical, and Electrical Construction Work

Bidders:

LUMP SUM BASE BID

The undersigned Bidder, with a complete understanding of existing conditions at the Project Site and a complete understanding of the Bidding Documents, including any Addenda acknowledged hereinafter, for IU South Bend Parking Lot Maintenance Project on the Indiana University South Bend campus, as prepared by Wightman, hereby proposes to complete the project, in full and complete accordance with the requirements of the Bidding documents, for the LUMP SUM BASE BID PRICE of:

\_\_\_\_\_ Dollars \$ \_\_\_\_\_  
(written amount) (numerals)

MAJOR SUBCONTRACTORS

Subcontractors and other persons and organizations proposed by the Bidder and accepted by the Owner and the Owner’s Representative must be used on the work for which they were proposed and accepted and shall not be changed except with the written approval of the Owner and the Owner’s Representative.

If requested, the supplemental Subcontractors and Products List will be submitted by email to the Owner, [bidtab@iu.edu](mailto:bidtab@iu.edu), and Wightman, Melanie Stanage, [mstanage@gowightman.com](mailto:mstanage@gowightman.com) within 48 hours of the bid opening. The understanding of the Owner and the design team is that these same Major Subcontractors will be the same subcontractors listed below.

The Contractor proposes to utilize the following primary subcontractors for the work indicated.

**List one major subcontractor per trade.** Any deviation could result in the Owner removing the bid from consideration.

Indicate which are certified by the State of Indiana as an MBE, WBE, or VBE company by circling the M/W/VBE after the name.

Asphalt Paving:	_____	M/W/VBE
Earthwork/Removals:	_____	M/W/VBE
Concrete:	_____	M/W/VBE
Pavement Markings:	_____	M/W/VBE

UNIT PRICES

1. The following Unit Prices shall include all costs necessary for the complete installation of the materials or items indicated, including materials, labor, equipment, operations, administration, overhead, profit and taxes (if applicable).
2. These Unit Prices shall be used to determine the costs for changes in the work during the construction period, when agreed upon by the Owner.
3. These Unit Prices are submitted as a price per unit of measurement for materials or services added to or deducted from the Contract Sum by appropriate modification, if estimated quantities of Work required by the Contract Documents are increased or decreased.
4. The Bidder shall submit one Unit Price for each of the following items, plus any other Unit Prices requested in the Bidding Documents, in the manner indicated.

	<u>Item</u>	<u>Unit</u>	<u>Price</u>
1.	<b><i>HMA, Intermediate, Type B</i></b>	<u>TON</u>	\$ <u>          </u>
2.	<b><i>HMA, Surface, Type B</i></b>	<u>TON</u>	\$ <u>          </u>
3.	<b><i>Removal and Replacement of Curb</i></b>	<u>FT</u>	\$ <u>          </u>

### TAX EXEMPTIONS

The undersigned Bidder has informed himself and all his prospective sub-contractors and suppliers of the tax exempt status of the Owner, as set forth in the General Conditions, and therefore, has not included these taxes in his Lump Sum Base Bid price.

### SUBSTITUTIONS

The undersigned Bidder has based his bid upon the materials, products, articles, equipment, brands, manufacturers and processes described in the Bidding Documents or upon approved equivalents. Proof of equivalency of substitutions is the responsibility of the Bidder, but the Architect/Engineer shall be the sole judge of equivalency. Proposed equivalent substitutions shall be equal in all respects to the requirements of the Bidding Documents, including but not limited to the design, quality, physical size, performance characteristics, strength, previous history of use, and to the method of installation, attachment, or connection to related or adjoining work. Determination of equivalency of proposed substitutions shall be by the Architect/Engineer, before the bid opening date, as described in paragraph entitled "Substitutions" in the Instructions to Bidders.

### COMPLETION DATE

The Undersigned Bidder agrees to coordinate and expedite his work and shall take into consideration any lead time and schedule parameters with all contractors, and that this Work will be completed no later than **August 1, 2025**

### ASSIGNMENT OF COORDINATION

The undersigned Bidder agrees to the assignment of Mechanical and Electrical work to the successful General Contractor for the responsibility of complete coordination of the work as stated in the Instructions to Bidders.

### PERFORMANCE AND PAYMENT BOND

The undersigned Bidder agrees, if awarded the Contract, to deliver to the Owner a satisfactory Performance Bond, in the full amount (100%) of the total Contract price, not later than the date of execution of the contract. The cost of the Bond shall be included in the Lump Sum Base Bid contained in this Proposal.

### SUPPLEMENTAL AND REQUIRED DOCUMENTS

Bid Security; State Form 96 (Revised 2013); Written Drug Testing Program, which must be in full compliance with IC 4-13-18; a completed Minority, Women's and Veteran's Business Enterprise Participation Plan; Contractor Asbestos Certification; Asbestos Protocol for Contractors.

### ADDENDA

The following Addenda have been received by the undersigned Bidder; and all costs resulting from these Addenda have been included in the preparation of this Bid Form:

Addendum No. \_\_\_\_\_ Dated \_\_\_\_\_

Addendum No. \_\_\_\_\_ Dated \_\_\_\_\_

Addendum No. \_\_\_\_\_ Dated \_\_\_\_\_

SIGNATURES

1. **When a Bidder is an Individual:**

\_\_\_\_\_  
Witness

\_\_\_\_\_  
Bidder

Date: \_\_\_\_\_

Address: \_\_\_\_\_  
\_\_\_\_\_

2. **When a Bidder is a Partnership:**

\_\_\_\_\_  
Name of Partnership

Date: \_\_\_\_\_

Address: \_\_\_\_\_  
\_\_\_\_\_

\_\_\_\_\_  
Partner

\_\_\_\_\_  
Partner

3. **When Bidder is a Corporation:**

\_\_\_\_\_  
Name of Corporation

Date: \_\_\_\_\_

Address: \_\_\_\_\_  
\_\_\_\_\_

By: \_\_\_\_\_  
President

Attest: \_\_\_\_\_  
Secretary

CORPORATE SEAL

END

**\*\*Submit bid online via [www.iuplanroom.com](http://www.iuplanroom.com)\*\***