

## Addendum-01

25 April 2025

To the Drawings and Specifications for:

**NW827 - ANDERSON LIBRARY CONFERENCE CENTER - East Dock Renovation - IU# 20240675**  
**Indiana University Northwest**  
**Gary, Indiana**

IU Project #: 20240675

HHAЕ #: IUN2402

Addendum Number One

### TO ALL BIDDERS, PLAN HOLDERS OF RECORD AND REGULATORY AGENCIES:

This Addendum supplements and amends the original and/or previously issued Construction Drawings and Project Manual, and shall be taken into account when preparing proposals, and shall become a part of the Contract Documents. Receipt of this Addendum must be acknowledged on the Proposal Form, failure to do so may subject the Bidder to being disqualified.

---

#### GENERAL REQUIREMENTS

---

**1.01 Reference:** General Information – Prebid Meeting Agenda and Sign-In.

**A. Clarification:** Attached is the Prebid Meeting Agenda and Sign-In Sheet held on 16 April 2025.

---

#### DRAWING ITEMS

---

**1.02 Reference:** Revised sheet A3.0 - LOADING DOCK ELEVATIONS with revised date 25 April 2025.

**A. Clarification:** Elevation Notes No. 6 was revised to clarify stainless steel guardrails finish type.

**1.03 Reference:** Revised sheet A4.0 - ENLARGED PLAN - LOADING DOCK STAIRS & DETAILS with revised date 25 April 2025.

**A. Clarification:** Section Detail Notes No. 11 & 12 were revised to reflect Drawing Item 1.02-A (above).

### END OF ADDENDUM NUMBER ONE

#### Attachments:

##### Architectural Items:

Pre-Bid Meeting Agenda

Pre-Bid Meeting Sign-In sheet dated 16 April 2025

Sheet A3.0-LOADING DOCK ELEVATIONS with revised date 25 April 2025.

Sheet A4.0-ENLARGED PLAN - LOADING DOCK STAIRS & DETAILS with revised date 25 April 2025.

JWH/jss

[info@hhaes.com](mailto:info@hhaes.com)

6832 Calumet Avenue  
Hammond, Indiana 46324  
219.932.2050



Est. 1895



## INDIANA UNIVERSITY

### INDIANA UNIVERSITY CAPITAL PROJECTS PRE-BID CONFERENCE AGENDA

Please visit the IU Plan Room, ([www.iuplanroom.com](http://www.iuplanroom.com)) to find out information on projects that are out for bids, how to obtain contract documents, a listing of plan holders, and addendums.

- Under “Site Options”, you can link to the “Bid Tabs & Awards” web site for the bid tabulation within 48 hours after bid opening.
- Questions – Main Contact: Justin Hutton (HHAES) at (219) 932-2050 or [jhutton@hhaes.com](mailto:jhutton@hhaes.com). IU: Joel Stevens, Architect at (317) 563-2319 or [joelstev@iu.edu](mailto:joelstev@iu.edu) - Gary Greiner, Director of Facilities at (219) 510-3287

#### 1. Introductions:

- a. IU Capital Project Representative
- b. IU Construction Management Representative
- c. IU User Representative
- d. Consultant

#### 2. Type of Bid:

- a. A Unified Bid is requested to include all General, Plumbing, Mechanical, and Electrical Work.
- b. Office of the Vice President for Capital Planning and Facilities via electronic bid submission on [www.iuplanroom.com](http://www.iuplanroom.com). Bidders must be registered on the plan room, and signed into the plan room, in order to submit a bid. Bids will be electronically opened via Zoom: <https://iu.zoom.us/j/82623978895>  
Meeting ID: 826 2397 8895  
Join By Telephone: 312-626-6799  
1:00 P.M. CT (Central Time) / 2:00 P.M. EDT (Eastern Daylight Time), on Wednesday, April 30, 2025.
- c. Bidders must use the provided Bid Proposal form in the Project Manual.
- d. Include with the Bid Proposal the Form 96, Contractor Asbestos Certification, Asbestos Protocol for Contractors, Bid Security in the amount of 5% of the bid, and the Minority and Women’s Business Enterprise Participation Plan.
- e. If the bid or project estimate is over \$150,000.00 a written plan for a program to test the Contractor’s employees for drugs is required to be submitted with the bid in accordance with IC 4-13-8.

#### 3. Base Bid, Allowances, Unit Prices and Alternate Bids (if any):

- a. Fill out the Bid Proposal form completely.
- b. Indicate Unit Prices as line items in the quantity indicated.
- c. No voluntary Alternates will be accepted. Bidders are required to provide what is called for in the documents. Product Substitutions will not be considered except as outlined in the General Conditions.

4. All written questions pertaining to the Bid Documents must be received not later than five (5) calendar days before Bid Opening.
5. Addendum can be issued no fewer than two (2) calendar days before Bid Opening. Please check the <http://www.iuplanroom.com> web site for addendum.
6. Project Temporary Facilities:
  - a. Job Site Office
  - b. Restrooms
  - c. Parking/Access to the Site
  - d. Site Security
  - e. Storage
7. Review of Tentative Construction Schedule:
  - a. Bid Opening Date:
  - b. Contract Award – 1 week
  - c. Contractor's Insurance Approval – 3 weeks
  - d. Begin Work: See Bid Proposal for date
  - e. Complete Work: See Bid Proposal for date
8. Questions pertaining to General Conditions or "Front End" documents.
9. Description of Scope of Work.
10. Tour of Facilities.



# HUTTON & HUTTON

ARCHITECTS & ENGINEERS

## Sign-In

<b>Notes:</b> The Sign-In indicates all attended parties, representatives, etc. regarding the project meeting at the stated location, date, and time.	<b>Meeting:</b>	Pre-bid Meeting
	<b>Project:</b>	IU Project No. 20240675 NW827 - Anderson Library Conference Center - East Dock Renovation
	<b>Project #:</b>	IUN2402
	<b>Location:</b>	Indiana University AT: 3400 Broadway Gary, Indiana 46408 Anderson Library Conference Center, First Floor Main Lobby
	<b>Date/Time:</b>	16 April 2025 - 10:00am/CST

Company	Name - Printed and Signed	Email Address/Phone Number
Indiana University	Gary Greiner Director of Facilities Services	<a href="mailto:gagreine@iu.edu">gagreine@iu.edu</a> / (219) 510-3287
Indiana University	Brian Klaum Project Manager, Construction	<a href="mailto:bdklaum@iu.edu">bdklaum@iu.edu</a> / (317) 946-4530
HHAЕ	Justin Hutton Architect	<a href="mailto:jhutton@hhaes.com">jhutton@hhaes.com</a> / (219) 932-2050
HHAЕ	Jasha Salas Architecture	<a href="mailto:jsalas@hhaes.com">jsalas@hhaes.com</a> / (219) 932-2050
<i>Carriup Const. Co.</i>	<i>Cale Summers</i>	<i>Cale.Summers@carriup.com</i>
<i>IUN</i>	<i>RANDY PEARL</i>	<i>rspearl@iu.edu</i>





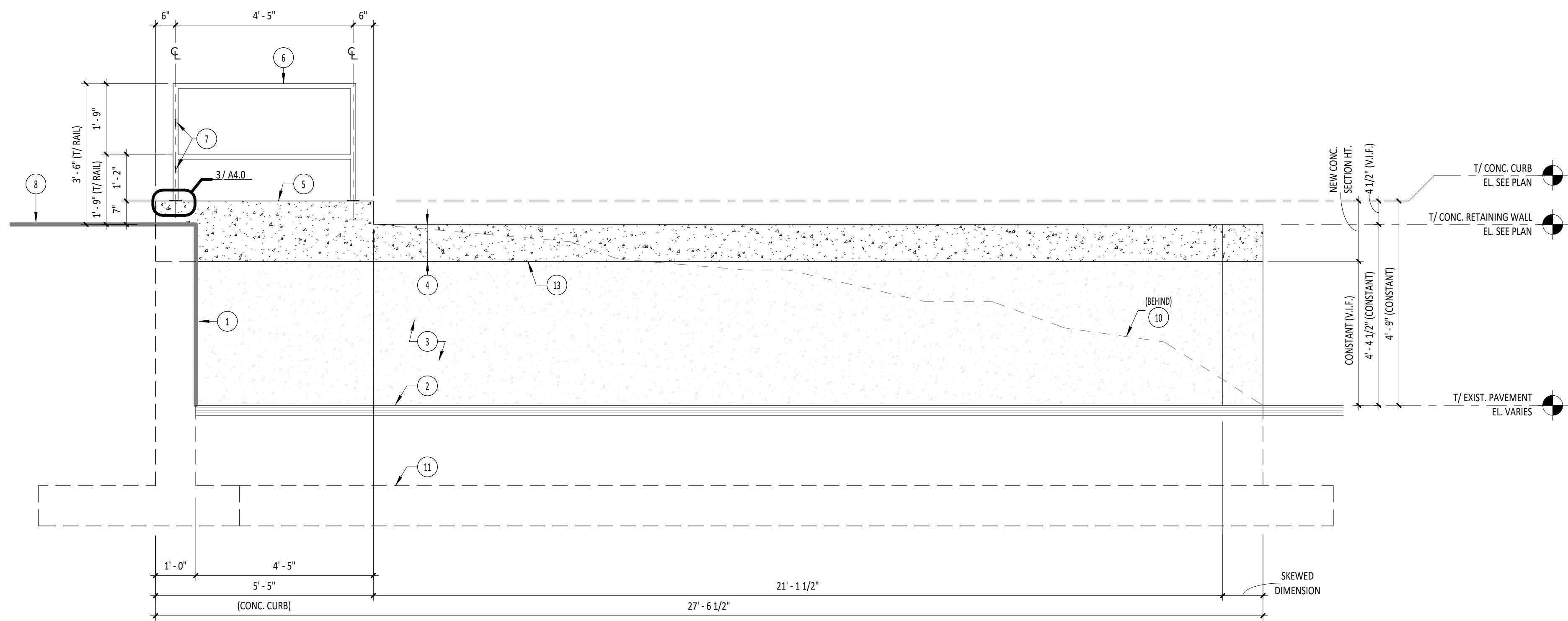

1 ELEVATION - LOADING DOCK - NORTH WEST

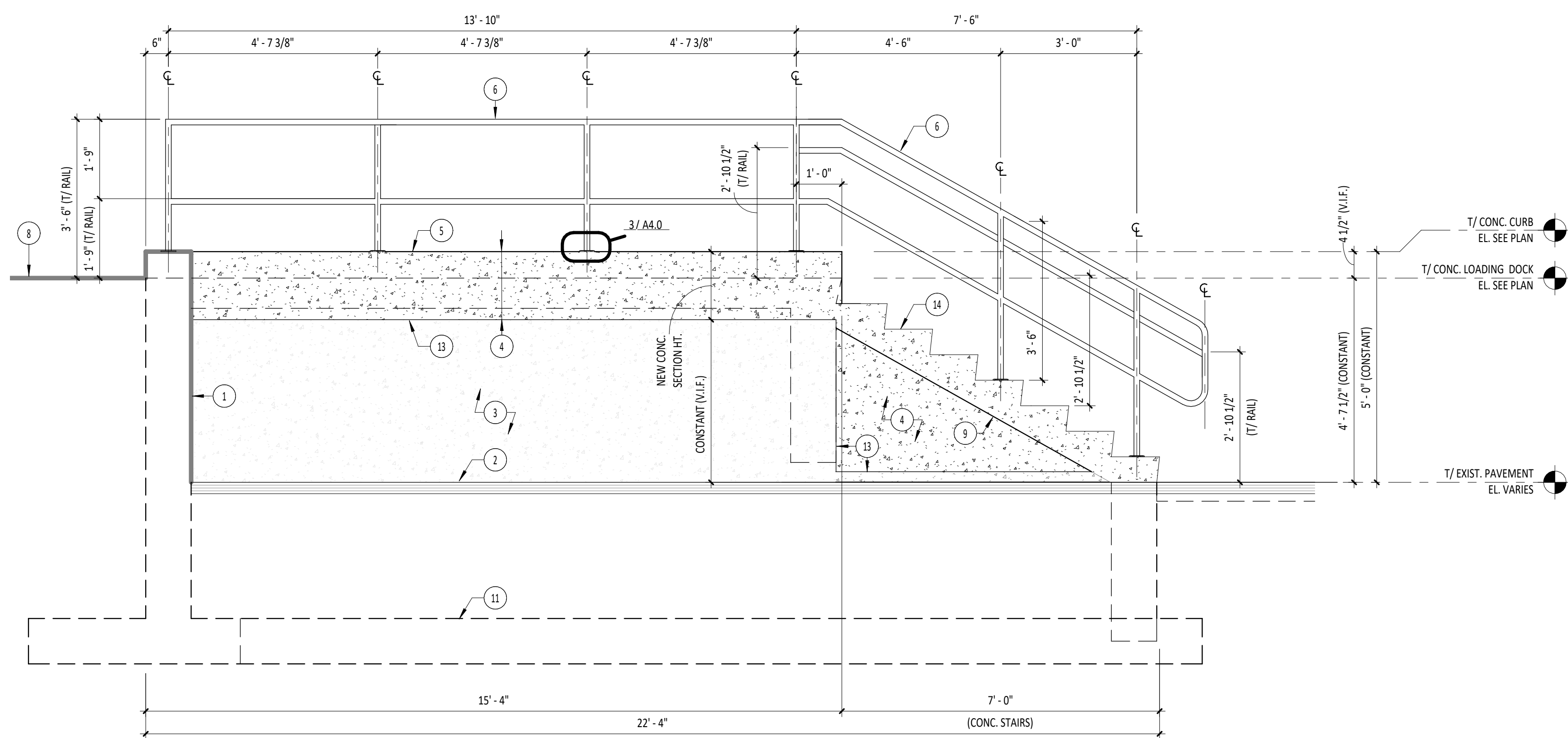

2 ELEVATION - DUMPSTER AREA - NORTH WEST

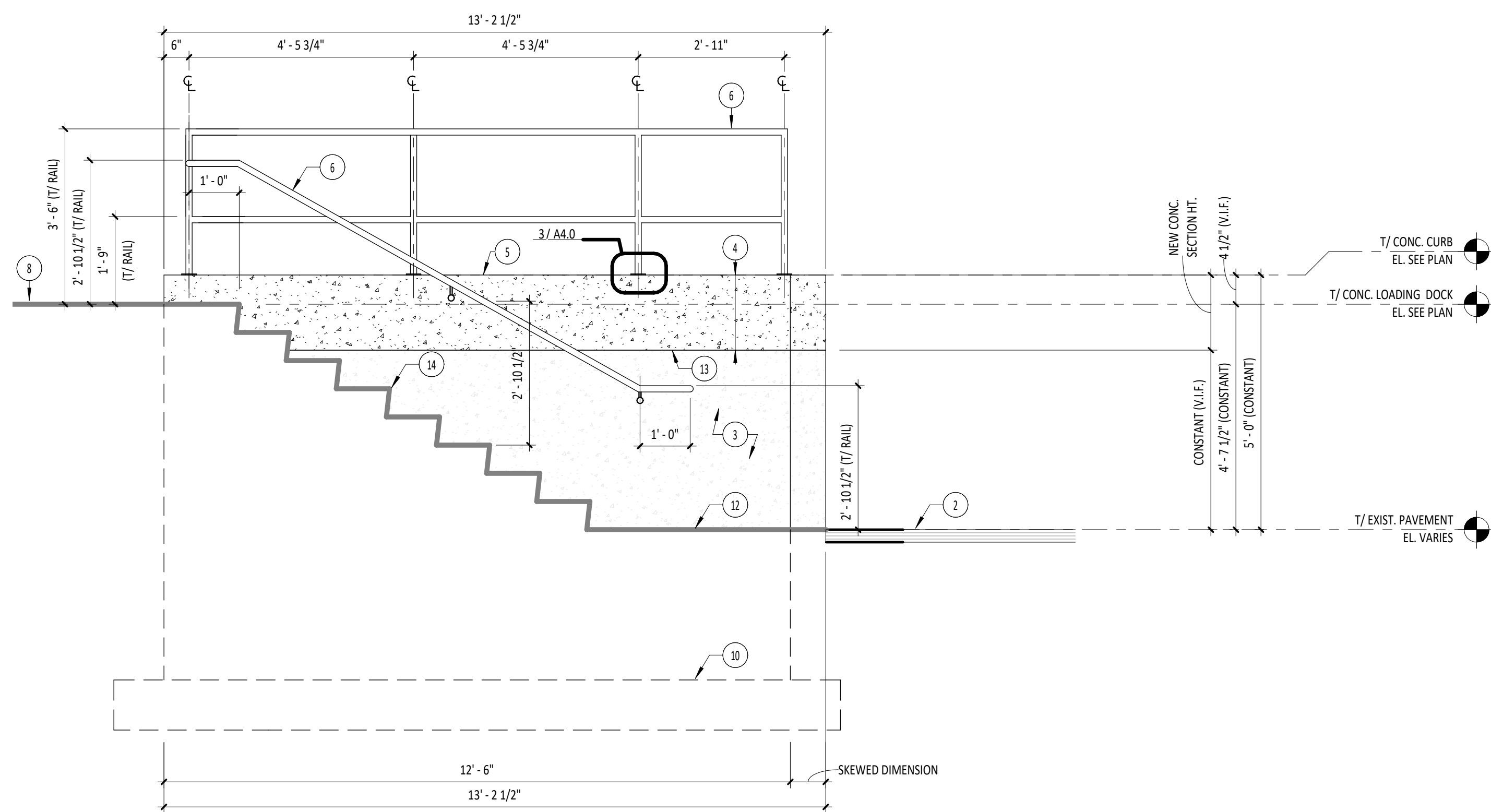

3 ELEVATION - STAIRS - NORTH WEST

## GENERAL NOTES - ELEVATION

1. REFERENCE STRUCTURAL DOCUMENTS FOR DELINEATION OF ALL WORK WITHIN THEIR RESPECTIVE PORTIONS OF WORK.
2. CONTRACTOR IS RESPONSIBLE TO VERIFY ALL EXISTING SITE CONDITIONS AND SHALL NOTIFY THE ARCHITECT IMMEDIATELY OF ANY DISCREPANCIES BETWEEN EXISTING CONDITIONS AND ALL ASSEMBLIES SHOWN IN THE CONSTRUCTION DRAWINGS.
3. CONTRACTOR SHALL VERIFY FINAL CONFIGURATION OF ALL EQUIPMENT/SYSTEMS, INCLUDING CONTRACTOR-FURNISHED CIVIL, STRUCTURAL, AND ARCHITECTURAL ITEMS ASSOCIATED WITH EQUIPMENT/SYSTEMS. VERIFY WITH THE OWNER AND ARCHITECT PRIOR TO COMMENCEMENT OF WORK RELATED TO THESE ITEMS.
4. ALL DIMENSIONS ARE FROM FINISH FACE OF WALL TO FINISH FACE OF WALL UNLESS OTHERWISE NOTED.
5. NO ELEMENT OF CONSTRUCTION SHALL BE ADDED TO THE EXTERIOR OF THE BUILDING WITHOUT APPROVAL OF THE ARCHITECT. ALL EXTERIOR ELEMENTS NOT SHOWN ON THE ELEVATIONS SHALL BE COORDINATED WITH THE ARCHITECT, AND FINAL LOCATIONS APPROVED BY THE ARCHITECT.
6. CONTRACTOR SHALL WORK WITH EXISTING SITE CONTOURS AND EXISTING SLAB ELEVATIONS TO SLOPE NEW CONCRETE SURFACES AWAY FROM THE NEW CONCRETE STAIRS.

## ELEVATION NOTES

- 1 EXISTING LOADING DOCK CONCRETE EDGE.
- 2 TOP OF EXISTING SLOPED BITUMINOUS PAVEMENT.
- 3 EXISTING CONCRETE RETAINING WALL.
- 4 REINFORCED CONCRETE WALL SECTION CAST ABOVE EXISTING RETAINING WALL. SECTION HEIGHT TO BE VERIFIED IN FIELD AND SHALL NOT EXCEED 2'-0\", UNLESS NOTED OTHERWISE. REFER TO WALL SECTIONS AND STRUCTURAL DRAWINGS.
- 5 CONCRETE CURB CAST INTEGRALLY WITH REINFORCED CONCRETE WALL SECTION. REFER TO WALL SECTIONS AND STRUCTURAL DRAWINGS.
- 6 1 1/2\"/>
- 7 PROVIDE STAINLESS STEEL LOOP WELDED TO GUARDRAIL POST FOR SUPPORT OF CHAIN LINK. COORDINATE SIZE AND HEIGHT WITH OWNER AND ARCHITECT.
- 8 TOP OF EXISTING SLOPED LOADING DOCK CONCRETE SLAB.
- 9 1/2\"/>
- 10 APPROXIMATE EXISTING BERM PROFILE TO REMAIN.
- 11 EXISTING WALL FOUNDATION TO REMAIN.
- 12 CONCRETE SLAB ON GRADE REFER TO SECTIONS AND STRUCTURAL DRAWINGS.
- 13 CONSTRUCTION JOINT BETWEEN NEW CONCRETE SECTION AND EXISTING REMAINING CONCRETE WALL. REFER TO SECTIONS AND STRUCTURAL DRAWINGS.
- 14 REINFORCED CONCRETE STAIRS. REFER TO SECTIONS AND STRUCTURAL DRAWINGS.

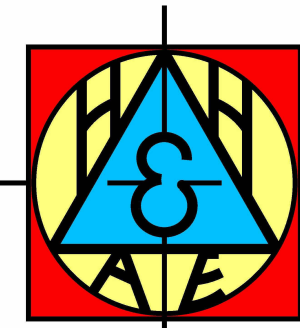

Hutton & Hutton Architects & Engineers  
6832 Calumet Ave. Hammond, IN, 46324  
(219) 932-2050 HHAES.com

## CONSULTANTS

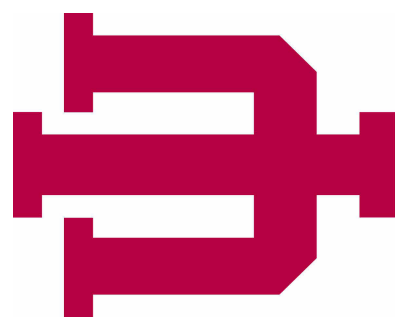

NW827 ANDERSON LIBRARY CONFERENCE CENTER - EAST DOCK RENOVATION  
INDIANA UNIVERSITY NORTHWEST - IUN# 20240675  
ANDERSON LIBRARY CONFERENCE CENTER - IUN CAMPUS GARY, INDIANA  
LOADING DOCK ELEVATIONS

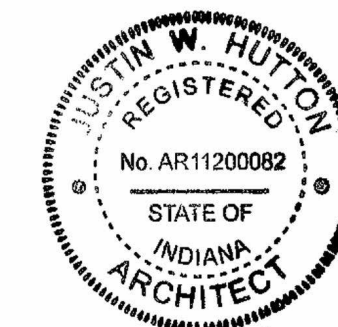

## CONSTRUCTION DOCUMENTS

THIS PRINT IS THE PROPERTY OF HUTTON & HUTTON ARCHITECTS & ENGINEERS AND IS CONFIDENTIAL. IT IS NOT TRANSFERABLE AND IS FURNISHED WITH THE CLEAR UNDERSTANDING THAT IT IS NOT TO BE TRACED OR OTHERWISE REPRODUCED WITHOUT PERMISSION AND IS RETURNABLE UPON REQUEST.

NO.	DESCRIPTION	DATE
1	ADDENDUM-01	04/25/25

ISSUE DATE: 02/19/2025

SHEET NO.  
**A3.0**  
JOB NUMBER  
IUN2402



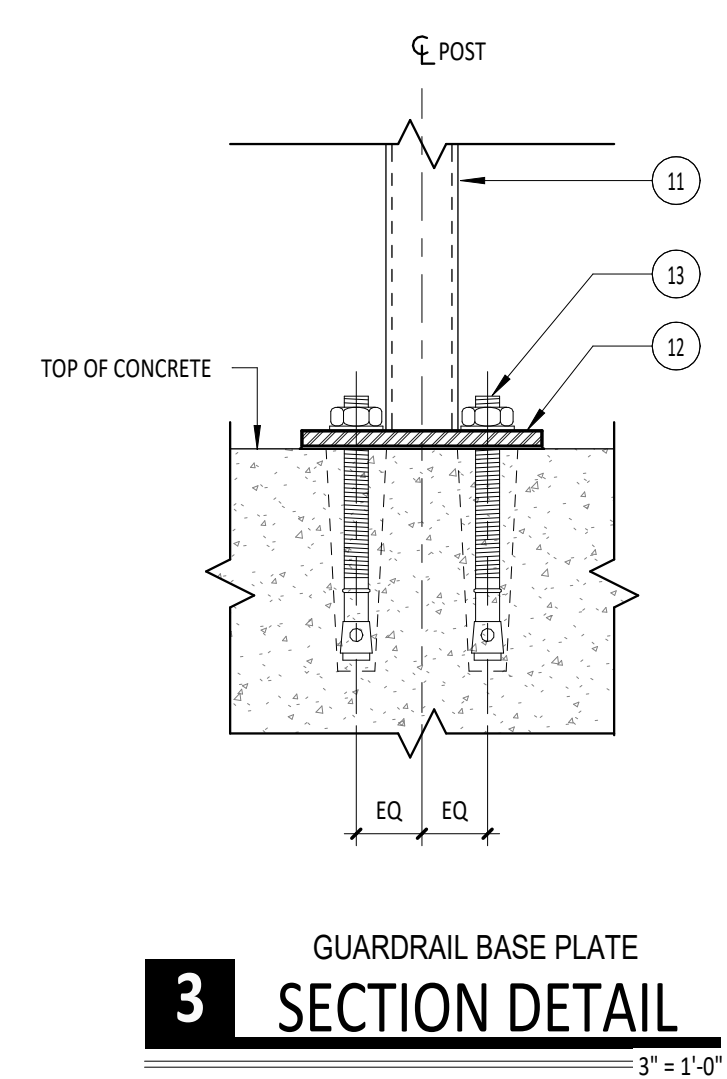
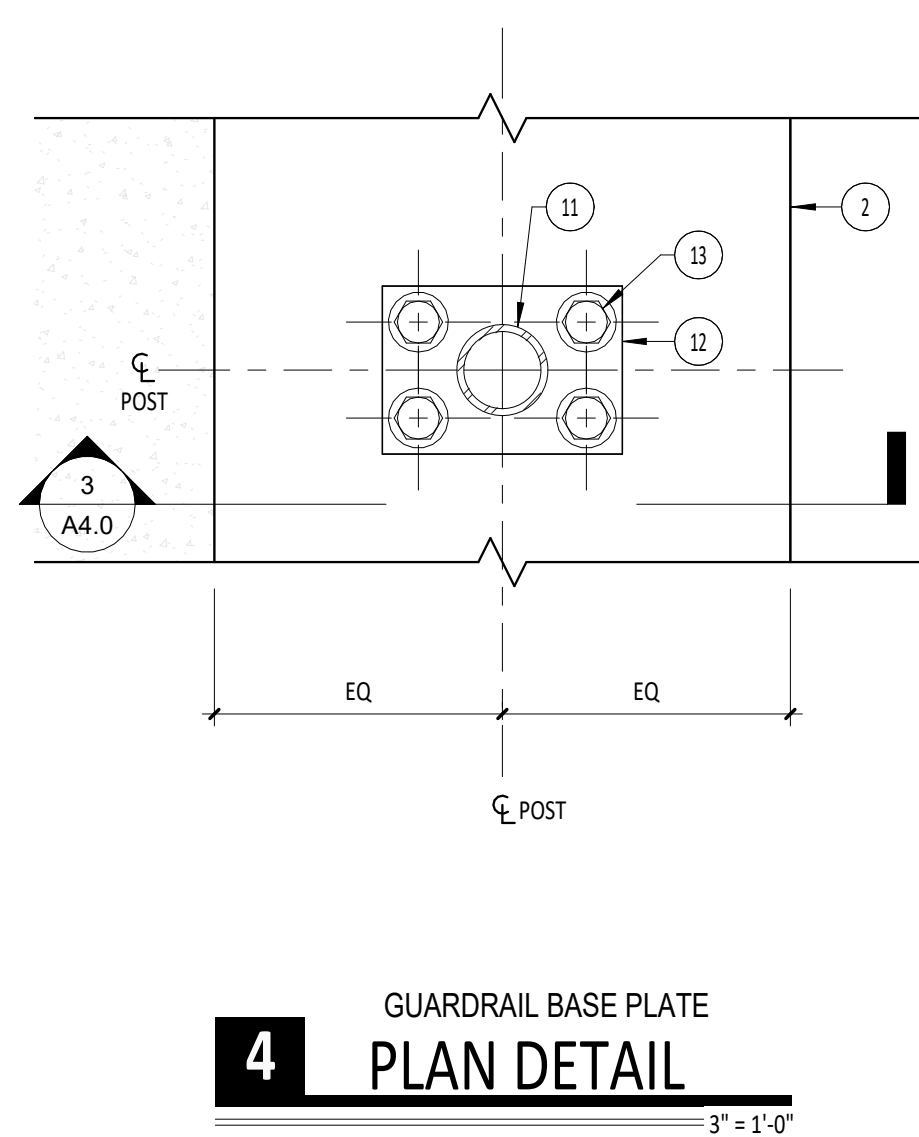
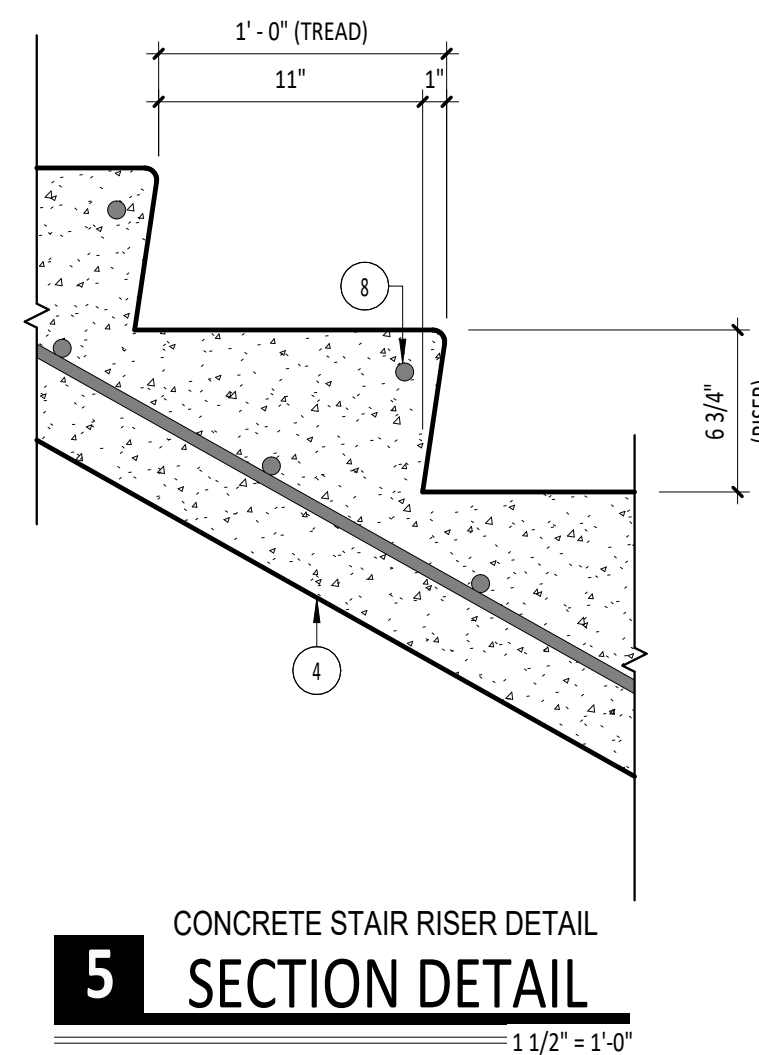
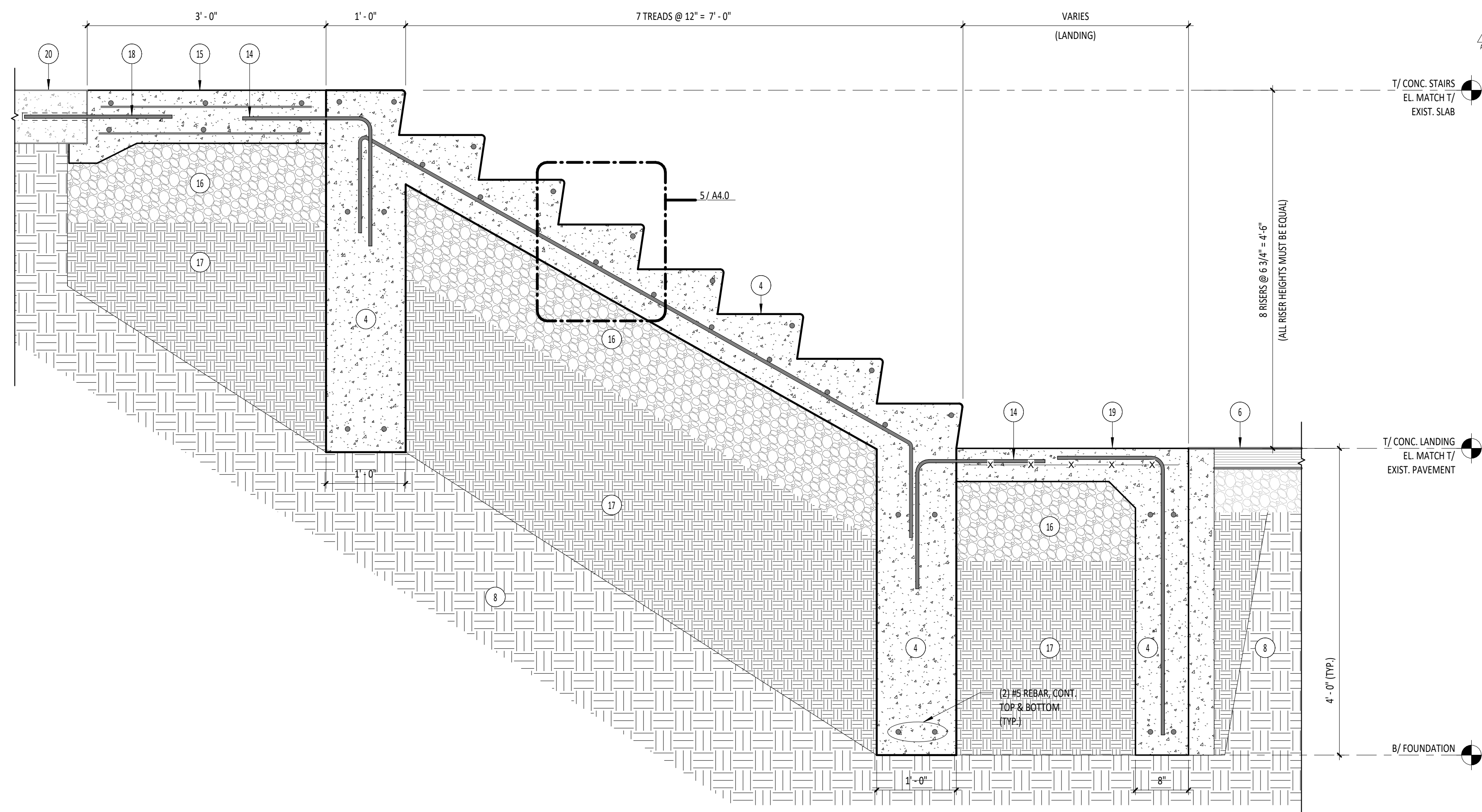
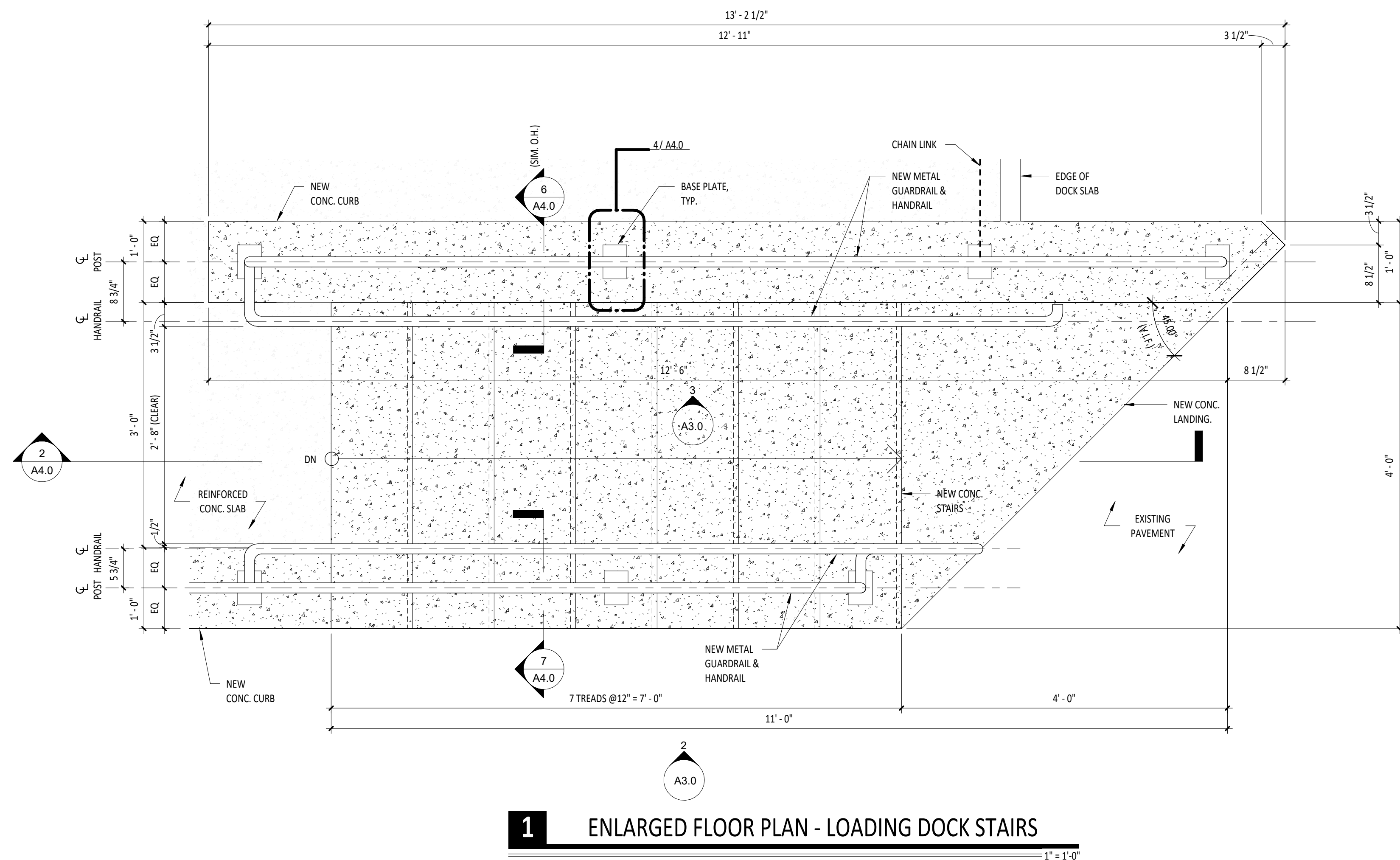
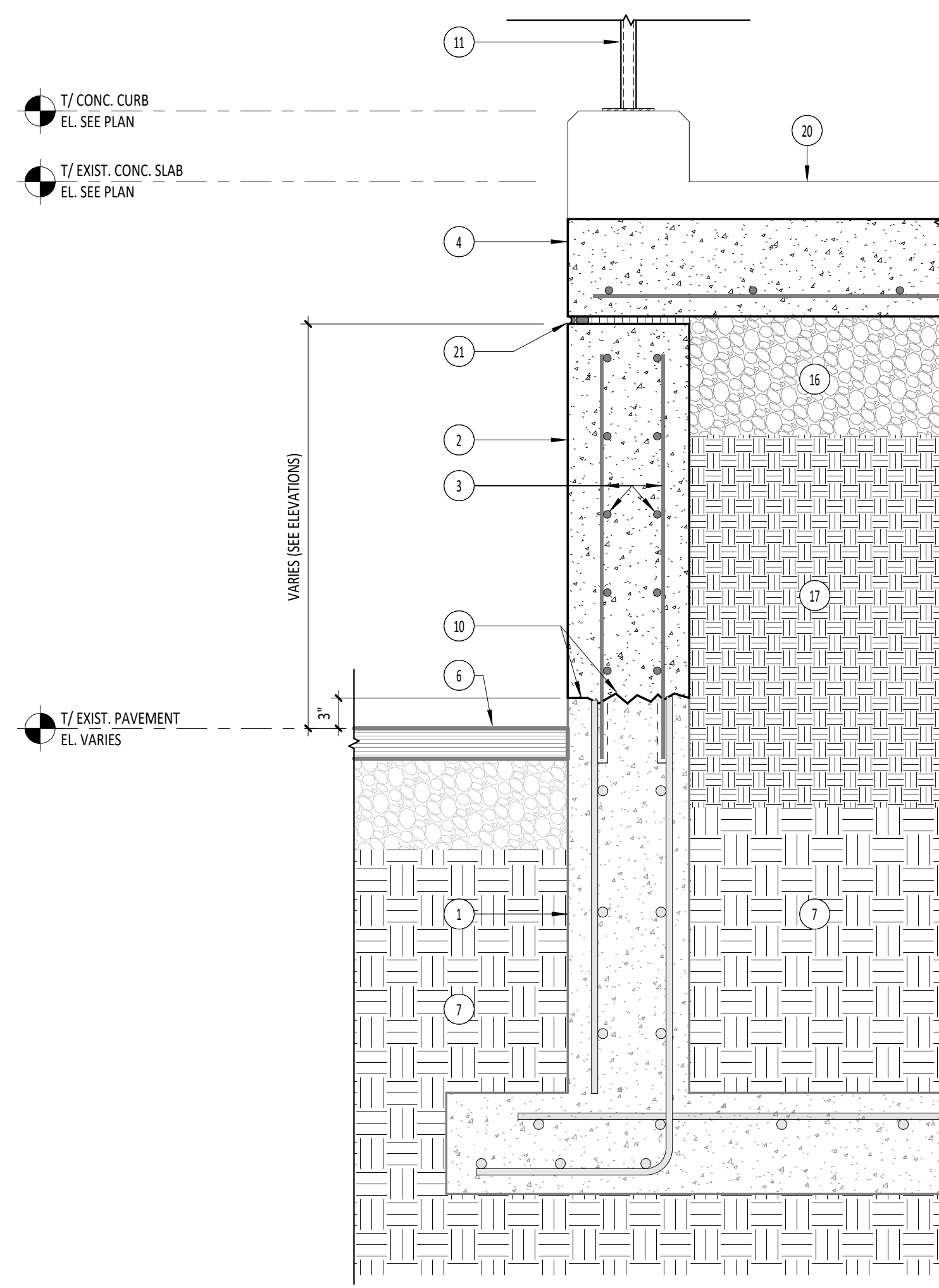
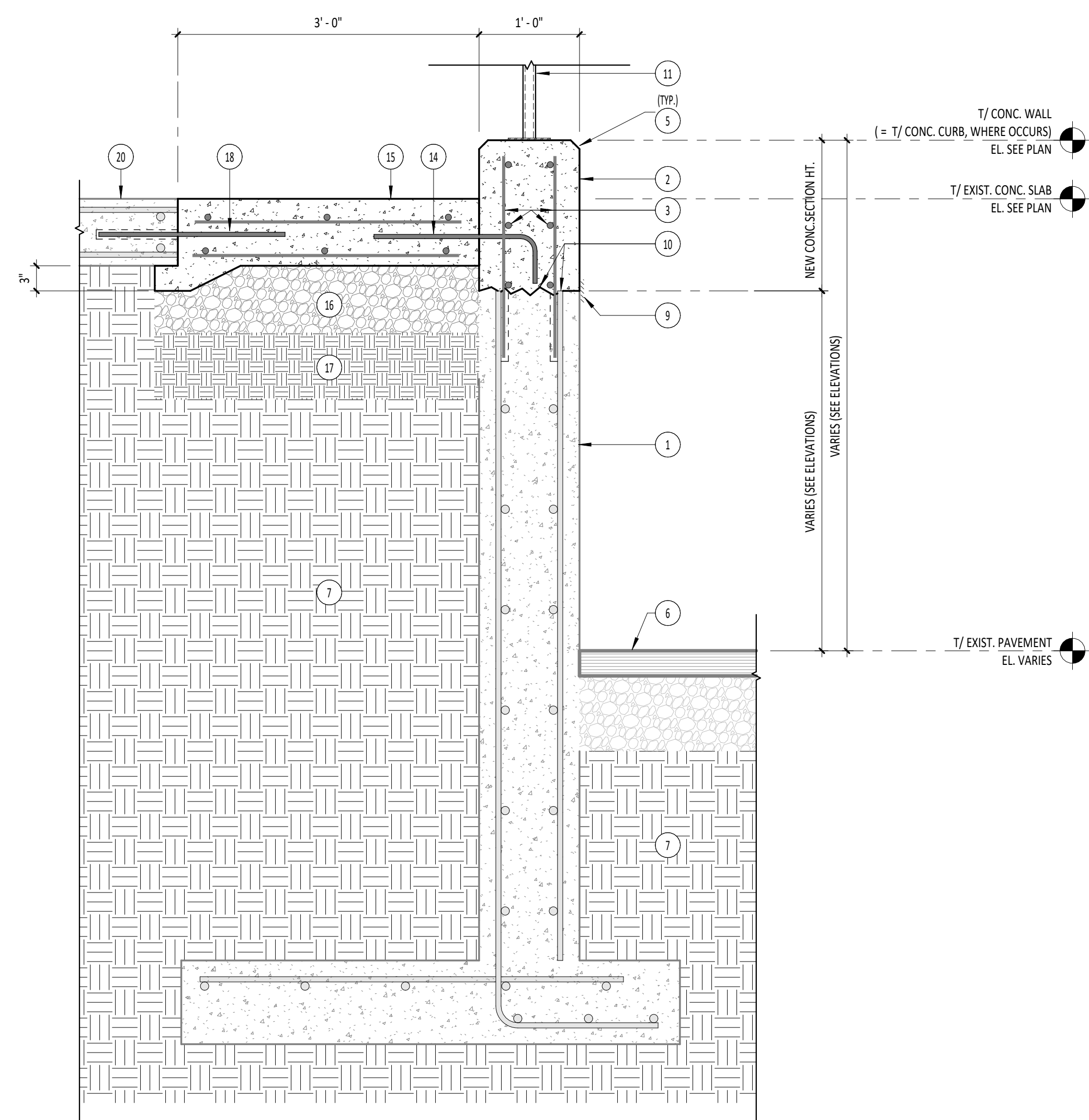

## GENERAL NOTES - ELEVATION

1. REFERENCE STRUCTURAL DOCUMENTS FOR DETERMINATION OF ALL WORK WITHIN THEIR RESPECTIVE PORTIONS OF WORK.
2. CONTRACTOR IS RESPONSIBLE TO VERIFY ALL EXISTING SITE CONDITIONS AND SHALL NOTIFY THE ARCHITECT IMMEDIATELY OF ANY DISCREPANCIES BETWEEN EXISTING CONDITIONS AND ALL ASSEMBLIES SHOWN IN THE CONSTRUCTION DRAWINGS.
3. CONTRACTOR SHALL VERIFY FINAL CONFIGURATION OF ALL EQUIPMENT SYSTEMS, INCLUDING CONTRACTOR FURNISHED CIVIL, STRUCTURAL, AND ARCHITECTURAL ITEMS ASSOCIATED WITH EQUIPMENT SYSTEMS. VERIFY WITH THE OWNER AND ARCHITECT PRIOR TO COMMENCEMENT OF WORK RELATED TO THESE ITEMS.
4. ALL DIMENSIONS ARE FROM FINISH FACE OF WALL TO FINISH FACE OF WALL UNLESS OTHERWISE NOTED.
5. NO ELEMENT OF CONSTRUCTION SHALL BE ADDED TO THE EXTERIOR OF THE BUILDING WITHOUT APPROVAL OF THE ARCHITECT. ALL EXTERIOR ELEMENTS NOT SHOWN ON THE ELEVATIONS SHALL BE COORDINATED WITH THE ARCHITECT, AND FINAL LOCATIONS APPROVED BY THE ARCHITECT.
6. CONTRACTOR SHALL WORK WITH EXISTING SITE CONTOURS AND EXISTING SUB ELEVATIONS TO SLOPE NEW CONCRETE SURFACES AWAY FROM THE NEW CONCRETE STAIRS.

## SECTION DETAIL NOTES

- 1 EXISTING REINFORCED CONCRETE RETAINING WALL TO REMAIN.
- 2 REINFORCED CONCRETE WALL SECTION CAST ABOVE EXISTING RETAINING WALL. REFER TO PLAN AND STRUCTURAL DRAWINGS.
- 3 PROVIDE #5 VERTICAL BARS @ 16" O.C. EACH FACE, AND #5 HORIZONTAL BARS @ 16" O.C. DOWEL VERTICAL BARS IN EPOXY GROUT AS SHOWN IN SECTION.
- 4 CONCRETE STAIRS AND FOUNDATION. REFER TO STRUCTURAL DRAWINGS.
- 5 3/4" CHAMFERED CORNER.
- 6 EXISTING BITUMINOUS PAVEMENT TO REMAIN.
- 7 EXISTING UNDISTURBED SUBGRADE TO REMAIN.
- 8 NOSING REBAR. REFER TO STRUCTURAL DRAWINGS.
- 9 UPON FORM REMOVAL, CONTRACTOR SHALL RUB NEW AND EXISTING CONCRETE.
- 10 PROVIDE CONTINUOUS ROUGHENED SURFACE AT BOTTOM OF NEW CONCRETE SECTION, AND EPOXY COAT ALL EXPOSED EXISTING REBAR TERMINATIONS.
- 11 STAINLESS STEEL GUARDRAIL POST. REFER TO GUARDRAIL ELEVATIONS FOR FINISH TYPE.
- 12 3 1/2" X 5" X 5/16" STAINLESS STEEL BASE PLATE WITH FULL BED OF EPOXY SET INTO BELOW PLATE. REFER TO GUARDRAIL ELEVATIONS FOR FINISH TYPE.
- 13 (1/4") 1/2" DIAMETER X 5 1/2" STAINLESS STEEL EXPANSION BOLTS WITH WASHERS EMBEDDED IN EPOXY.
- 14 EPOXY COATED #4 X 6" X 18" REBAR HOOK @ 18" O.C.
- 15 NEW REINFORCED CONCRETE SLAB SECTION. MATCH DEPTH AND TOP SLOPE TO THAT OF EXISTING CONCRETE SLAB. REINFORCE WITH #5 EACH WAY @ 12" O.C. EACH WAY, TOP & BOTTOM.
- 16 12" THICK LAYER OF COMPACTED GRAVEL.
- 17 COMPACTED SUBGRADE/BACKFILL.
- 18 EPOXY COATED #5 X 18" REBAR @ 24" O.C. D. DOWELED INTO EXISTING CONCRETE WITH EPOXY.
- 19 5" CONCRETE SLAB ON GRADE WITH WELDED WIRE MESH REINFORCEMENT.
- 20 EXISTING REINFORCED CONCRETE SLAB ON GRADE.
- 21 1" SOLATION JOINT MADE OF COMPRESSED FILLER BOARD SEALED WITH BACKER ROD AND SEALANT ON EXPOSED FACE OF CONCRETE WALL. REFER TO WALL SECTIONS.

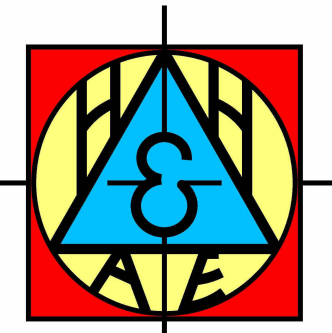

Hutton & Hutton Architects & Engineers  
6832 Calumet Ave. Hammond, IN, 46324  
(219) 932-2050 HHAES.com

## CONSULTANTS

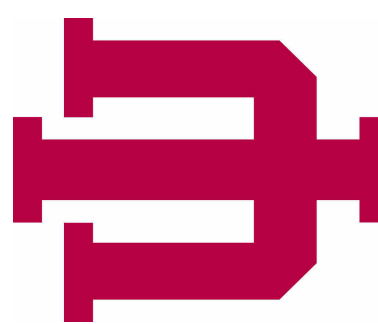

NW827 ANDERSON LIBRARY CONFERENCE CENTER - EAST DOCK RENOVATION

INDIANA UNIVERSITY NORTHWEST - IU# 20240675

ANDERSON LIBRARY CONFERENCE CENTER - IUN CAMPUS GARY, INDIANA  
ENLARGED PLAN - LOADING DOCK STAIRS & DETAILS

## ENLARGED PLAN - LOADING DOCK STAIRS & DETAILS



**CONSTRUCTION DOCUMENT:**

THIS PRINT IS THE PROPERTY OF  
HUTTON & HUTTON ARCHITECTS  
& ENGINEERS AND IS CONFIDENTIAL.  
IT IS NOT TRANSFERABLE AND  
IS FURNISHED WITH THE CLEAR  
UNDERSTANDING THAT IT IS NOT  
TO BE TRACED OR OTHERWISE  
REPRODUCED WITHOUT PERMISSION  
AND IS RETURNABLE UPON REQUEST.

[illegible]

ISSUE DATE: **02/19/2025**

SHEET NO.

## A4.0

JOB NUMBER  
**IUN2402**