

ADDENDUM NO. 1

To: Construction Documents dated March 27, 2026

Project: BL000A Site - Woodlawn Stormwater Collection System (Railroad)
IU 20192159

BRCJ Project No.: 10570

Date: April 8, 2026

This Addendum, issued prior to bidding alters, amends, corrects, or clarifies the Proposal Documents to the extent stated herein and does thereby become a part of the Proposal Documents and will become part of the Contract Documents is the successful bidder.

ITEMS INCLUDED IN THIS ADDENDUM

- A. Answers to questions as noted below.
- B. Meeting agenda and sign in sheet from the April 6, 2026 pre-bid meeting.
- C. NRSS Flagging Services Request Form.
- D. Excerpt from 2015 Design Drawings.
- E. Revised C201 Site Preparation , Demolition, & Restoration Plan.
- F. Chilled Water Construction Photographs (7)

ANSWERS TO QUESTIONS

- Q1: How should bidders anticipate the cost of compliance with INRD requirements for working in railroad right of way?
- A1: Base Bid shall include an allowance of \$10,000 for expenses related to Railroad Flagging Services to be provided by National Railroad Safety Services, Inc. The contractor performing the work will be required to have a flagman from National Rail Safety Services (NRSS) on-site whenever men or equipment are within twenty-five (25) feet of nearest rail. NRSS request form with daily rates is attached for reference. Contact Dave Shepherd for details: (513) 671-6633, dwshepherd@nrssinc.net. Contractor will need to complete INRD Contractor Orientation Training prior to commencing work in the INRD R/W. Contact Risa McElroy for details: rmcelroy@nrssinc.net Contractor will be responsible for obtaining the proper level of insurance coverage for working within the INRD R/W. More information is available here: <https://www.inrd.com/permits>. Additionally note, Allowance No. 5 pertains to Railroad Flagging Services only. Contractor will be responsible for obtaining the proper level of insurance coverage for working within the INRD R/W. Please refer to Specification Section 012100 Allowances.
- Q2: Should temporary construction fencing be post-driven, or on stands?
- A2: Temporary stands would be acceptable for this project. Please note that red privacy screen (Pantone 201) will be required per standard IU CPF general requirements, and contractor shall provide sandbags as needed to hold bases in place in the event of wind.
- Q3: What is the orientation of StormTech chambers and inlet manifold in the UG detention system?
- A3: Design drawings from 2015 are attached for reference. As-built conditions have not been verified.

- Q4: Is third-party testing required for the asphalt paving?... Or is a proof roll acceptable?
A4: Third-party testing is not required. Contractor will be expected to evaluate subgrade conditions with Engineer after pave-drain strips are removed. Contractor and Engineer will jointly determine the need for undercut and/or geogrid installation prior to placement of base aggregate. Contractor is expected to proof roll the compacted aggregate with Engineer present prior to placement of asphalt.
- Q5: How deep are the chilled water lines under the east curb line?
A5: Chilled water lines have not been potholed for this project, exact depth below grade is not known. It is expected that the proposed storm inlets and piping will be installed above the chilled water lines without conflict. Photographs from the installation of the chilled water lines are attached for reference. IU may pothole at proposed inlet locations, results of potholing to be provided by Addendum if/when they are available.
- Q6: There appears to be additional silt fence that doesn't seem to serve a purpose looking at existing grades on site. Should the contractor still install this silt fence per plan?
A6: See attached revised C201.
- Q7: Where will contractor staging or parking be located?
A7: To be determined and released with Addendum #2.

CHANGES TO PROJECT MANUAL

None

CHANGES TO PROJECT PLANS

- C201 Site Preparation , Demolition, & Restoration Plan:
- Revised limits of silt fence placement.
 - Clarification for protecting open excavations.
 - Revised limits of temporary site protection fencing.

ATTACHMENTS

Meeting Agenda and Sign-In Sheet from the April 6, 2026 Pre-Bid Meeting
NRSS Flagging Services Request Form
Excerpt from 2015 Design Drawings, showing StormTech Underground Detention
Revised C201 Site Preparation , Demolition, & Restoration Plan.
Chilled Water Construction Photographs (7)

END OF ADDENDUM ONE

AGENDA: Pre-Bid Meeting

Project: BL000A Site - Woodlawn Stormwater Collection System (Railroad) - IU 20192159
Date: April 6, 2026
Time: 1:00 pm
Location: N Woodlawn Avenue & E 12th Street.

1. Introductions

- a. Indiana University
 - University Utility Operations: Scot Osborn
 - IU Construction Manager: Matt Harms
- b. Consultant Team
 - Civil Engineer: BRCJ - (812) 336-8277
 - Andy Knust, PE
 - Ben Blanton, Technician

2. Contract Documents

- a. Available from Eastern Engineering: 317-598-0661 or www.iuplanroom.com

3. Project Information

- a. Project Description: Project generally includes selective site demolition, excavation, storm drainage construction, asphalt paving, and site restoration.
- b. Project must be complete no later than **August 14, 2026**.

4. Bidding Procedures

- a. Electronic bids are due on **April 17, 2026** no later than 2:00 pm (local time) via electronic bid submission on www.iuplanroom.com.
 - Bidders must be registered on the plan room, and signed in to the plan room in order to submit a bid.
 - Contact Rhonda with questions about submitting/uploading bids 812-855-2089
- b. Bid to Include:
 - Bid Form
 - 5% Bid Bond
 - Indiana State Form 96 with Current Financial Statement
 - Written Drug Testing Plan in accordance with IC 4-13-18
 - Minority, Women's, Veteran's Owned Business Enterprise Participation Plan
 - Refer to Instruction to Bidders for additional information
- c. Addenda
 - Addenda are distributed to all plan holders via Eastern Engineering
 - Final Addendum no later than **noon, Wednesday, April 15, 2026**.
- d. Protocol for Questions
 - Questions are to be in writing, emailed to Bledsoe Riggert Cooper James to the attention of:
 - **Andy Knust**, aknust@brcjcivil.com, cc Ben Blanton, bblanton@brcjcivil.com

- Questions must be submitted by **12:00 PM (local time) on Tuesday April 14, 2026**. Questions received after this time will not be answered.

5. Project Website

- a. Indiana University eBuilder

6. Site Logistics & Coordination

- a. Woodlawn Ave. is a City of Bloomington Street, coordinate work with Planning and Transportation Dept.
 - ~~Contractor will be responsible for ROW excavation permits~~
 - Maintenance of Traffic plan has been reviewed by City staff, approval will be required by Board of Public Works.
 - Next BPW meetings are **May 4th & May 19th**. The following will need to be submitted in advance of the meeting:
 1. A request letter to the Board Members with full description of project.
 2. A site plan indicating the location of signage for the detour.
 - Contractor to coordinate closure with BFD Station No. 3
 - **Scot Osborn (IU) has submitted a ROW Excavation Permit on behalf of the successful contractor. Reference Civic Access # ROW2026-04-2420.**
- b. Work in RR R/W subject to approval by INRD. Temporary Entry Permit is the responsibility of the contractor.
 - Coordinate with Bernie Guerrettaz: bernie.guerrettaz@inrd.com

7. Other Items

- a. Testing – Third party testing will not be required. Contractor will be expected to evaluate subgrade conditions with Engineer after pave-drain strips have been removed. Contractor and Engineer will jointly determine the need for undercut and/or geogrid installation prior to the placement of base aggregate.
- b. 100% Performance and Payment Bond Required
- c. Contractor is required to repair/replace any existing materials/construction damaged or displaced by construction operations, including landscape and lawns, to match existing; to be approved by Owner.
- d. Contractor will be responsible for protection of existing chilled water lines under east curb.

8. Comments, Questions, Discussion

- a. *Refer to addendum #1 for additional questions and responses.*
- b. *Irrigation in proximity to work will be investigated to determine whether or not it is active and will need to be restored to service.*
 - *Scot Osborn will follow up with IU Landscaping Services.*
- c. *IU may pot-hole CHW at proposed inlet locations. Results of potholing to be provided by Addendum if/when they are available.*
- d. *BRCJ will follow up with INRD concerning the acceptability of CMP trench drain.*

PRE-BID MEETING SIGN IN SHEET

Project: BL000A Site - Woodlawn Stormwater Collection System (Railroad) - IU 20192159
Date: April 6, 2026
Time: 1:00 pm
Location: N Woodlawn Avenue & E 12th Street.

NAME	REPRESENTING	EMAIL ADDRESS	PHONE NUMBER
Andy Knust	BRCJ	aknust@brjcivil.com	812-336-8277
Ben Blanton	BRCJ	bblanton@brjcivil.com	812-336-8277
Jeff Doley	E413	JEFF.DOLEY@EIRAVINC.COM	812.512.0681
SCOT OSBORN	IU	SCOSBORN@IU.EDU	
Matt Harms	IU	harmsm@IU.edu	812-856-4116
AS Chandler	Milestone	aj.chandler@milestonelp.com	812-322-4507
Joe Cummings	Cider & Cider	jcummings@ciderandcider.com	317-296-7670
James Underwood	SKB	James.Underwood@SKBPipesolutions.com	812-797-7389
Thomas Gott	Milestone	thomas.gott@milestonelp.com	812-330-2037



**The Indiana Rail Road, Co.
Third Party Request
Roadway Worker In Charge (RWIC) Services Agreement**
Do not sign this form if you are not the responsible party paying for this service!

Project Name: _____ **Date:** _____

Duration (Start & End Date): Start on _____ and end on _____

Project Physical Address: _____

If Not Available Provide Coordinates: Latitude: _____ *Longitude:* _____

Start & Stop Times: Begin each day at _____ and end at _____

Description of Work: _____

(Attach any plans indicating work area)

Work Crew: The work will be performed by: _____

The equipment used will be: _____

Railroad Permit# _____

(You are required to have a valid permit number)

Party Responsible for Payment: _____

This contract must be completed and signed by the entity responsible for payment of services

Contact Name / Title: _____

Phone: _____ **Fax:** _____ **Email:** _____

Address: _____

Accounts Payable Contact: _____

Phone: _____ **Fax:** _____ **Email:** _____

Billing Address: _____

Purchase Order Number: _____

(List P.O. # or Project # you wish for us to include in our invoice)

Continued on next page.

Fee Schedule

STANDARD WORK DAY:	
Standard 8 Hour Day:	\$736.00
Overtime Rate After 8 Hour Day:	\$138.00
Double-Time After 12 Hour Day:	\$184.00
NIGHTS, WEEKENDS, AND HOLIDAYS:	
Saturday Standard 8 Hour Day:	\$1,104.00
Overtime Rate After 8 Hour Day:	\$184.00
Sunday & Holidays Standard 8 Hour Day	\$1,472.00
INCIDENTALS:	
Travel Time, Portal to Portal, Per Hour:	\$50.00
Per Diem, Meals & Lodging, Per Night:	\$165.00
Hi-Rail Vehicle, When Required, Per Hour:	\$30.00

SPECIAL NOTE: Prior to working within this railroad's right of way, all personnel may be required to complete a Roadway Worker Training Protection or Contractor Orientation Training Course as mandated by The Indiana Rail Road, Co. Consult your issued permit for details.

<p>National Railroad Safety Services Roadway Worker In Charge (RWIC) Services Details</p>
--

This request for service shall be submitted fourteen (14) calendar days in advance of any work to be performed within twenty-five (25) feet of nearest rail.

Note: All projects are scheduled on a first come, first served basis. Customers must be flexible with their schedules.

NRSS reserves the right to cancel and reschedule for any reason at no charge to the customer. NRSS will not be liable for any expenses incurred by the customer and their subcontractors/suppliers, etc.

A RWIC will be required when men or equipment are within the railroad's right of way (typically twenty-five (25) feet of nearest rail). This includes any equipment in the vicinity with the potential to tip over or encroach within twenty-five (25) feet of the nearest rail. (FRA Mandate).

Once the request has been approved, a RWIC will be provided by NRSS at the cost of the customer.

Additional time may be charged for set up of On Track Protection such as Form B's. This typically adds up to two (2) additional billable hours. The railroad determines when this method of protection is required.

A minimum two day charge applies for one day projects.

Any cancellations must be made twenty-four (24) hours in advance of the scheduled start time, day of service to avoid being charged a minimum of 8 hours.

Projects involving any excavation or boring must be coordinated with the respective Railroad Signal Personnel (by territory) a minimum of 72 hours prior to beginning the project to locate any buried

cable. Railroad Signal Personnel will either mark where signal cable is buried or verify worksite to be free of any cables, track wires or other signal devices that could be potentially affected by the project. No work will be performed by contractor(s) until a cable locate has been performed. Railroad reserves the right to charge the contractor separately for this service. All other utilities must be located by the respective owner of utility.

Customer's personnel, subcontractors, etc. must remain in full compliance with safety policies and procedures as prescribed by the railroad and in accordance with the Code of Federal Regulations Title 49, Part 214 Railroad Workplace Safety. Non-compliance could result in immediate removal, permanent ban and possible prosecution by railroad and/or the Federal Railroad Administration.

For scheduling and/or cancelations, contact NRSS Midwest District Manager:

David Shepherd

Phone: (513) 755-4910 EXT. 104

Cell: (513) 617-6633

[Email: dwshepherd@nrssinc.net](mailto:dwshepherd@nrssinc.net)

This proposal must be signed by an authorized representative (customer) and returned via email.

Unless prior arrangements are made, NRSS invoices on a weekly basis. All payments are due upon receipt.

A late charge of 18% or a minimum of \$100.00 will be due and payable for unpaid invoices over thirty (30) days past due.

Prevailing wage projects will be quoted separately. Note: RWIC's are not Traffic Control Flaggers nor Laborers. Don't assume prevailing wage applies to RWIC Services unless specified. *Administrative fees will apply.*

Customer requesting a RWIC must have authorization from The Indiana Rail Road, Co. to work inside their right of way and have all required permits, insurance, and training (if required) in place at the time of scheduling.

NRSS is not responsible for any incidents/damage/injury/loss of life by contractor's personnel/subcontractors, etc. for not abiding by the railroad's safety rules and/or not complying with the RWIC instructions.

Scope of Services

National Railroad Safety Services agrees to provide a RWIC and other staff support services to customer or its contractors (the "Services") at the agreed upon dates, locations and times requested by customer. The Services will be provided pursuant to the terms and conditions in the Agreement. National Railroad Safety Services will require employees and any subcontractors and agents involved in the providing such Services to comply with the applicable terms of this Agreement in providing such Services. National Railroad Safety Services warrants that (i) Services will be provided in a workmanlike manner, (ii) National Railroad Safety Services Personnel will have the requisite

experience, skills, knowledge, training and education to perform services in a professional manner and in accordance with this Agreement; and (iii) Services will be provided in compliance with all governmental laws, regulations, and rules, and in accordance with Maintenance of Way and Signal Department On-Track-Safety Roadway Worker Rules and the Company's Operating Rules. A Scope of Services/Service Quote shall be prepared for each site at which the Services are to be performed, and it shall become a part of this Agreement when authorized in writing signed by each party's authorized representative. The Scope of Services will set forth, at a minimum, the cost, location, dates, times and expected number of personnel required for each job site.

Services Agreement

This Services Agreement ("Agreement") is entered into by and between National Railroad Safety Services, Inc. (NRSS) and the entity or individual ("Customer") described in the Scope of Work/Customer Information Request. The SOW is expressly incorporated herein by reference for all purposes. The SOW also provides National Railroad Safety Services charges for services requested. This Agreement shall become effective upon the earlier of the Customer's executing this agreement or National Railroad Safety Services reasonably undertaking to perform services requested by the Customer (the "Effective Date").

WHEREAS Customer desires to retain National Railroad Safety Services to provide certain services described and set forth in further detail in the SOW (the "Services"); and

WHEREAS, National Railroad Safety Services has the capability and capacity to provide the Services and subject to the terms and conditions set forth herein is willing to perform such Services; and

In consideration of the mutual covenants and agreements hereinafter set forth and for other good and valuable consideration, the receipt and sufficiency of which are hereby acknowledged, National Railroad Safety Services and Customer (hereinafter, collectively, the "Parties," or each, individually, a "Party") agree as follows:

1. National Railroad Safety Services shall provide Services to the Customer: (1) in accordance with the terms of this Agreement; (2) within any parameters set forth in the SOW; and (3) to the reasonable satisfaction of the Customer. In turn, the Customer shall pay National Railroad Safety Services for its services at the applicable daily rate(s) set forth in the SOW.

2. National Railroad Safety Services shall periodically provide Customer with invoices that set forth the value of the Services provided to Customer during a defined period of time (collectively, the "Invoices"; individually, an "Invoice"). Invoiced amounts are due and payable within thirty (30) days of the date included on an Invoice, and Customer shall remit payment to National Railroad Safety Services at 7395 Kingsgate Way, West Chester, Ohio 45069. Customer has the option of paying via credit card but will be charged a 3% processing fee. No payment shall be considered made until actually received by National Railroad Safety Services. In the event Customer fails to timely remit payment to National Railroad Safety Services as required in this Section 2, National Railroad Safety Services may elect to immediately cease providing Services to Customer without providing any advance notice to Customer until Customer remits payment for all amounts owed by Customer for Services. Customer expressly agrees and acknowledges that it shall neither assert nor seek to enforce any claim for damages or penalties arising from National Railroad Safety Services ceasing

performance under this Section 2. National Railroad Safety Services' right to cease providing Services based on nonpayment and/or untimely payment is independent of any right(s) set forth in Section 5 of this Agreement.

3. In the event that Customer contests any charge(s) included on an Invoice and/or asserts that any Services described in an Invoice were deficient, Customer shall submit a written complaint to National Railroad Safety Services (a "Complaint") within fifteen (15) business days of its receipt of the challenged Invoice. A Complaint must set forth (in detail): (1) the Services and/or Invoice entries that Customer is contesting; (2) the basis for Customer's Complaint; and (3) Customer's desired solution. Failure to timely submit a Complaint shall constitute a waiver of any grievances related to the subject Invoice and shall further be construed as an unequivocal agreement to pay all amounts described therein.

4. Customer may terminate this Contract, in whole or in part, at any time without cause, and without liability except for required payment for services rendered by providing at least twenty-four (24) hours written notice to National Railroad Safety Services. Failure to provide timely notice under this provision shall obligate Customer to pay National Railroad Safety Services for one (1) additional days' worth of Services at the applicable daily rate(s) set forth in the SOW.

5. National Railroad Safety Services may terminate this Agreement without liability, effective upon providing notice to Customer, if Customer: (1) materially breaches a provision of this Contract and fails to cure its breach within fifteen (15) days after receipt of written notice of its breach, or (2) becomes insolvent or admits and/or demonstrates its inability or unwillingness to pay its debts as they become due.

6. This Agreement shall commence as of the Effective Date and shall continue thereafter until the Services described in the SOW are completed or the Contract is terminated.

7. This Agreement benefits solely the Parties hereto and their respective successors and permitted assigns. Nothing in this Agreement, express or implied, confers on any third party any legal or equitable right, benefit or remedy of any nature whatsoever under or by reason of this Agreement.

8. This Agreement may not be altered, amended, modified, or otherwise changed, except by a writing duly executed by the Parties hereto.

9. This Agreement constitutes the final and entire agreement between the Parties, and this Agreement supersedes all prior representations, understandings and agreements, if any, among or between the Parties.

10. The failure of any Party to enforce at any time any provision of this Agreement shall not be construed to be a waiver of such provision, nor in any way affect the validity of this Agreement or any part thereof or the right of any person thereafter to enforce each provision. No waiver of any breach of this Agreement shall be held to constitute a waiver of any other breach.

11. This Agreement shall be interpreted and construed under the laws of the State of Ohio, and venue for all suits arising out of or relating to this Agreement shall be brought exclusively in an Ohio state district or county court sitting in Butler County, Ohio.

12. All invoices, requests, communications, and notices required to be sent to Customer shall be delivered to the address(es) and/or email address(es) set forth in the SOW. All Complaints, requests, communications, and notices required to be sent to National Railroad Safety Services shall be sent to National Railroad Safety Services at 7395 Kingsgate Way, West Chester, OHIO 45069, Attention: Tim Shepherd. Any notice of termination and/or cancelation shall be sent to National Railroad Safety Services at tshepherd@nrssinc.net

13. Neither of the Parties shall be liable for any delays or failures in performance due to acts of God, strikes, lockouts, labor restrictions by governmental authority, civil riots, war and acts of terrorism.

14. In the event of any subsequent litigation involving the interpretation or enforcement of this Agreement, the prevailing Party shall be entitled to recover from the non-prevailing Party all its costs and reasonable attorneys' fees incurred in connection with the lawsuit.

15. In connection with National Railroad Safety Services providing the Services, National Railroad Safety Services agrees to obtain the following insurance policies:

(1) a Commercial General Liability policy with limits of not less than \$1,000,000 per occurrence and \$2,000,000 general aggregate (the "CGL Policy") with the following enhancements

- (a) Additional Insured for Ongoing Operations only (note – completed operations is not applicable and additional insured status will not apply)
- (b) Waiver of Subrogation in respect to Additional Insured
- (c) Apply primary for any covered cause of loss
- (d) Per project aggregate

(2) a Commercial Automobile Liability policy with limits of not less than \$1,000,000 (collectively, the "Policies") covering any owned, hired, and non- owned auto for bodily injury and property damage, with the following enhancements.

- (a) Additional Insured per written contract
- (b) Waiver of Subrogation in respect to Additional Insured
- (c) Apply primary for any covered cause of loss

(3) a Workers Compensation policy with statutory coverage and Employers Liability coverage of no less than \$1,000,000 with the following enhancement

- (a) Waiver of Subrogation in respect to Certificate Holder

These coverages will provide 30-day notice of cancellation if required by Customer

The Policies shall include Customer as additional insureds (collectively, the "Additional Insureds") for all coverage excluding Workers Compensation. Coverage for the Additional Insureds shall be primary and non-contributory to any other insurance maintained by Customer. Coverage for Additional Insureds under the CGL Policy shall be set forth via an ISO endorsement form CG 20 26 04 13 (or equivalent endorsement), unless otherwise limited by applicable law. The Policies shall include a Waiver of Subrogation in favor of Customer. National Railroad Safety Services agrees to provide Customer with Certificate(s) of Insurance that verify the foregoing.

In addition, National Railroad Safety Services agrees to maintain Workers' Compensation insurance (the "WC Policy") with limits established by statute in the state where the Services will be provided. All National Railroad Safety Services employees providing Services shall be covered under the WC Policy, including employees who are sole proprietors, members, or partners, whether or not required by applicable law. The WC Policy shall also include a Waiver of Subrogation in favor of Customer.

Each insurer providing insurance coverage as stated above will maintain AM Best ratings of "A- VII" or better.

16. National Railroad Safety Services and Customer each agree to indemnify, defend, and hold the other harmless from any third- party claims, costs, liabilities, judgments, expenses, or damages (including reasonable attorneys' fees and other costs of suit) alleged to arise from the indemnifying party's sole negligence in performing their respective obligations under this Agreement.

If you have any questions regarding this quote and/or service agreement, or would like further information, please feel free to contact National Railroad Safety Services.

By my signature, I acknowledge that I have read, understand, and agree to the terms in this quote and service agreement

Customer Company Representative (Signature)

Customer Company Representative (Print Name)

Title

Date

National Railroad Safety Services (Signature)

National Railroad Safety Services (Print Name)

Title

Date

If you have any questions regarding this quote and/or service agreement, or would like further information, please feel free to contact National Railroad Safety Services.

The Indiana Rail Road Co. - Third Party Request
Roadway Worker In Charge (RWIC) Services Agreement

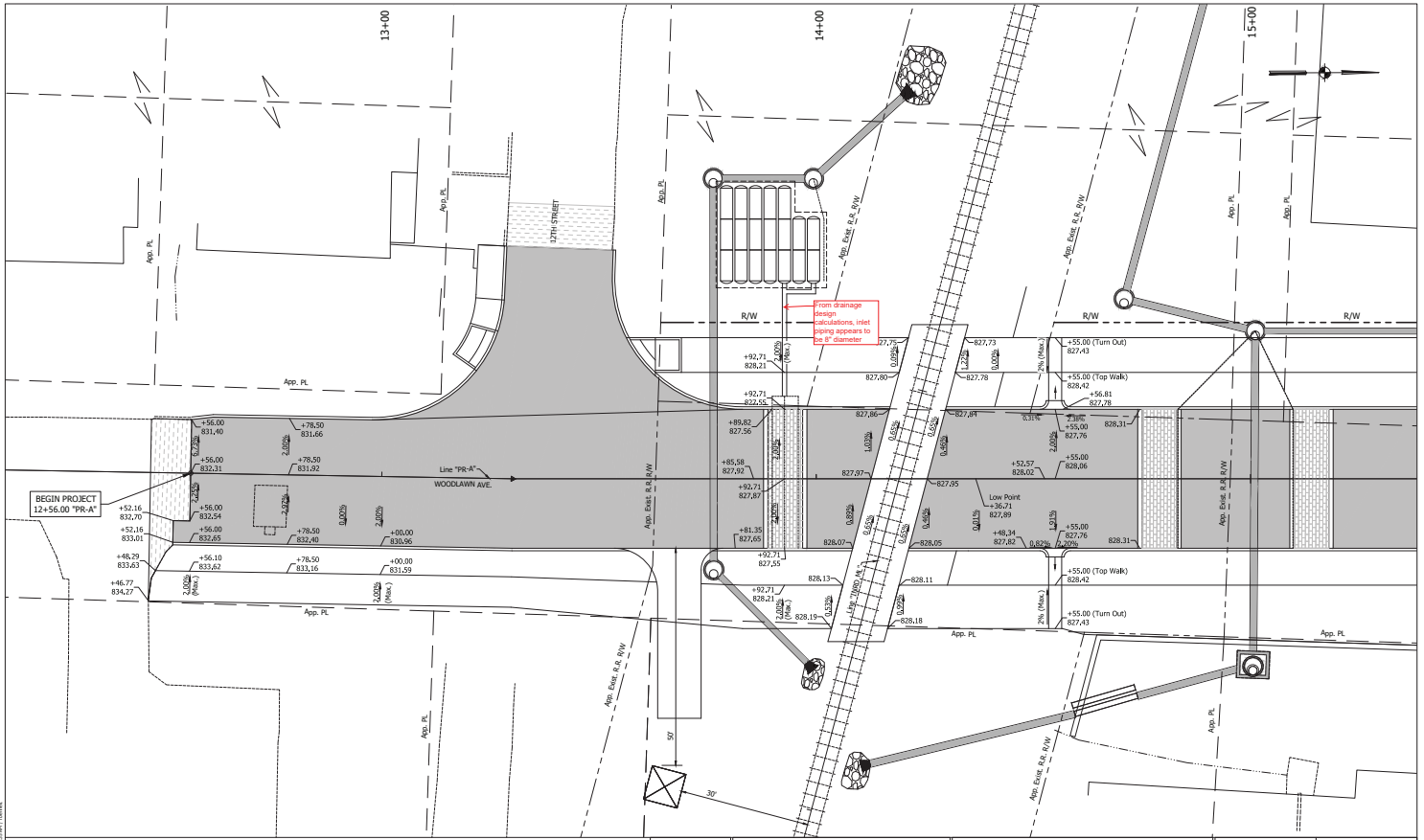

DESIGNED BY: J.A. [unreadable] DATE: 05/11/2011
 DRAWN BY: J.A. [unreadable] DATE: 05/11/2011
 CHECKED BY: M.B. [unreadable] DATE: 05/11/2011

STAGE 3	RECOMMENDED FOR APPROVAL:	DESIGN ENGINEER:	DATE:	INDIANA DEPARTMENT OF TRANSPORTATION	HORIZONTAL SCALE:	BRIDGE FILE:
	DESIGNED: M.B.	DRAWN: J.A.			VERTICAL SCALE:	DESIGNATION:
	CHECKED: M.B.	CHECKED: M.B.			SURVEY BOOK:	SHEETS:
					CONTRACT:	PROJECT:
				SPOT ELEVATIONS	RJ3834	1500380









West side of Chilled Water Plant

New 36" Chilled Water supply & return being lowered for Woodlawn Ave. expansion

North

To E. 13th St





Intersection of E. 13th St. & Woodlawn Ave.

West side of Chilled Water Plant

New 36" Chilled Water supply & return being lowered for Woodlawn Ave. expansion

North

3-6-2014
Looking South down
Woodlawn Ave.

CHW towers

2-36in CHW lines

H
&
M
C

