

**MSKTD**  
& Associates, Inc.

**ARCHITECTURE ENGINEERING INTERIOR DESIGN**  
1715 MAGNAVOX WAY, FORT WAYNE, INDIANA 46804  
PH. 260-432-9337

---

---

**ADDENDUM NO. D-3**

---

---

**INDIANA UNIVERSITY SOUTHEAST SIDE RESIDENCE HALL**  
**BLOOMINGTON, INDIANA**  
**IU Project No. 20106837**  
**MSKTD Project No. 5804**  
**February 3, 2012**

This addendum is issued as a supplement to the plans and specifications and shall be considered an integral part of the same.

ITEM	LOCATION	DESCRIPTION
D3.1	Specifications Section 006020	Project Site Requirements (added by Addendum D-1):  Article 2, F & G: As the building is currently designed, there appears to be no need for the work as outlined in these two portions of this article in the specifications - disregard.  Article 17, B, 4: The cost for the General Contractor to park in the Purple Lot and the Athletic Lot shall be FREE. All transportation shuttle costs to the construction site are by General Contractor.
D3.2	Specifications Section 012100	Part 3, 3.1, A:  Change the amount of Contingency Allowance #1 from \$100,000.00 down to \$30,000.00.
D3.3	Specifications Section 033000	Part 3.9, C: The rubbed finish on any concrete is to be applied only to areas that are specifically called out as such. If the wall is not indicated as "rubbed finish" it shall be stripped of forms and inspected for normal construction. Knocking off of large material will be necessary for general appearance and to permit other construction. All walls that are covered will not require a rubbed finish.
D3.4	Specifications Section 034100	Clarification: No bonding agent is required for the pre-cast plank prior to the installation of the 2 inch topping. Cleaning and preparation is necessary as required by ASTM and the PCI Design handbook for Precast and Prestressed Concrete.

ITEM	LOCATION	DESCRIPTION												
D3.5	Specifications Section 044300	2.1 STONE SCHEDULE  ADD paragraph D, subparagraph 2 as follows: 1. Bybee Stone Company, Inc., (812) 867-2215												
D3.6	Specifications Section 044313.13	Part 1.6, B, 1: The mock up size indicated is not accurate. Follow the approximate scaled size mockups shown on the elevation and wall section drawings.  Delete Part 3.5, C, 1. We do not expect the contractor to install continuous wire reinforcement in the joints and attach them to seismic veneer anchors.  Clarification: The listing of colored mortar and standard mortar is in the specifications for the architect and owner to select from a full range of colors during the mockup approval process. Therefore, the mason should provide accordingly.												
D3.7	Specifications Section 093000	General clarification: The General Contractor might need to recess the slab in some locations for the larger glazed porcelain tiles to be installed properly for flush and level interface with other flooring materials. We do not want lip-age issues on this project. Coordinate with the tile subcontractor.												
D3.8	Specifications Section 095113	Addendum Item D1.020 - The Claro-T product approved in Addendum D-1 should have read Claro Finish project.												
D3.9	Specifications Sections 21, 22, & 23 Drawings Mechanical, Plumbing, and Sprinkler Sheets	Refer to the following table for status of approval for product substitutions.  <table border="1"> <thead> <tr> <th>Spec/ Drawing Ref.</th> <th>MFGR.</th> <th>Description</th> <th>Approved (Yes/No)</th> </tr> </thead> <tbody> <tr> <td>223500</td> <td>Ajax</td> <td>Water heaters</td> <td>Yes</td> </tr> <tr> <td>M6.1</td> <td>Nexus</td> <td>Valve Packages</td> <td>Yes</td> </tr> </tbody> </table>	Spec/ Drawing Ref.	MFGR.	Description	Approved (Yes/No)	223500	Ajax	Water heaters	Yes	M6.1	Nexus	Valve Packages	Yes
Spec/ Drawing Ref.	MFGR.	Description	Approved (Yes/No)											
223500	Ajax	Water heaters	Yes											
M6.1	Nexus	Valve Packages	Yes											
D3.10	Specifications Section 211000	3.5.A.1 & 3.5.A.2 – Schedule 10, roll grooved, “Victaulic” joints are approved.												
D3.11	Specifications Section 211000	3.10.N – Seismic bracing is not required on the sprinkler piping.												
D3.12	Specifications Section 220719	- Add to 2.12.B: Domestic Hot and Recirculated and Solar Water Heating System: - Add 2.13 OUTDOOR PIPING INSULATION SCHEDULE A. Domestic Hot Water (Solar Water Heating System) 1. NPS 1 1/4 inch and smaller: Insulation shall be: a. Flexible Elastomeric: 1” thick 2. NPS 1 1/2” and larger: Insulation shall be: a. Flexible Elastomeric: 1 1/2” thick B. All outdoor piping to include aluminum jacket.												

ITEM	LOCATION	DESCRIPTION
D3.13	Specifications Section 230540	1.3.B – Delete requirement that shop drawings must be signed and sealed by a professional engineer.
D3.14	Specifications Section 232113	9.3.1.C.2 & D.2 – Note: Type L copper is an acceptable material for pipe size 2-1/2” and larger.
D3.15	Specifications Section 270000	Delete all references to “General Cable 7131932 GenSPEED 6500” from the Horizontal Copper Cabling numbers.
D3.16	Specifications Section 283111	1.12.A.2 – Warranty Period: Change warranty period from five years to two years.
D3.17	Specifications Sections 312000 & Civil Structural Drawing	The Earthwork Removal Scope of work will now include additional earthwork removal below the “neat line” or “contractors construction sub-grade line” of work as follows: The General Contractor shall include in the base bid contract the means necessary to remove 5,000 additional cubic yards of existing dark or reddish brown moist, silty clay or organic material or fill type material that has been identified in the soils report that exists BELOW the intended removal line needed to install all base engineered foundations and sub-grade granular fill described in the drawings. This new scope of work is generally be located on the north wing of unit A but might also be located on the north end of unit C and could occur in pockets of all units. This additional excavation is not intended to include limestone or rock removal; only unacceptable fill material that would be located below the construction neat line.
D3.18	Specifications Section 321218	2.3 COURT PRODUCTS  ADD paragraph B, subparagraph 3 as follows:  3. ‘Laykold Acrylic Resurfacer’ as manufactured by Advanced Polymer Technology Group.  ADD paragraph B, subparagraph 3 as follows:  3. ‘Laykold Color Coat’ as manufactured by Advanced Polymer Technology Group.
D3.19	Specifications Section 321413	2.1 SOLID CONCRETE UNIT PAVERS  REPLACE paragraph B, subparagraph 3, with the following:  3. Paver Color ‘A’: UF-20 Paver Color ‘B’: UF-30 Paver Color ‘C’: UF-10

D3.20	Drawings Sheet L2.1	ADD the following note to the drawing:  NOTE: All <b>straight</b> control joints shown in concrete walks and plazas shall be sawn. All <b>curved</b> control joints shall be tooled. Provide expansion joints in all locations indicated by 'ej'. Refer to detail 13/L6.0.
D3.21	Drawings Sheet L4.0	ADD the following note to the drawing:  NOTE: All control joints indicated in the South Plaza shall be sawn. Refer to Sheet L2.1 for expansion joint locations.
D3.22	Drawings L2.0	MODIFY the Key Plan as indicated in the attached Drawings D1.056a through D1.056f. <i>(Note: This was Item D1.56 from Addendum D-1; the attachments are being reissued due to a printing error in Addendum D-1.)</i>
D3.23	Drawings 5/L6.4	ADD the attached Drawing D1.060, "Typical Stair Handrail." <i>(Note: This was Item D1.060 from Addendum D-1; the attachment is being reissued due to a printing error in Addendum D-1.)</i>
D3.24	Drawings S1.1	Under Precast Hollowcore Planks, add the following notes:  7. Provide openings for mechanical trades when opening requirements exceed 6" diameter. The General Contractor shall coordinate these requirements with the Precast Supplier and the Mechanical Contractor. These opening shall be provided for in the design and fabrication of the hollowcore planks.  8. Prestressing steel strands shall not be cut at field cut openings without approval of the manufacturer and the Structural Engineer.  9. The manufacturer shall submit, for approval, detailed shop drawings and calculations, stamped and signed by a Professional Engineer registered in the state of Indiana.
D3.25	Drawings S2.1a	Plumbing lines exit the building at two places on the east side of the building in Unit A. See sheet P2.0a for exact locations. At both of these locations, step the footings down 2'-0" for a length of 3'-0" and then step the footing back up to the elevation indicated in the corresponding foundation sections.
D3.26	Drawings S2.1b	In Unit B at the north end of lines 1 and 2, provide a beam pocket for W14 beams (Ref. S4.1b) bearing on foundation wall. Size to accommodate bearing plates.
D3.27	Drawings S2.1b	Omit the north-south 20'-2" dimension shown at the elevator shaft foundation wall. This dimension increases to approximately 21'- 0 3/4". Verify with architectural drawings.
D3.28	Drawings S2.1b	At the elevator shaft extend the north and east edge of the elevator mat footing 4'. In other words, the 2'-0" dimension shown on the left in section 43/S3.6 becomes 6'-0" on the north and east sides of the elevator shaft.

D3.29	Drawings S2.1b	Revise the wall footing on line 2 at the north side of Unit B to be 10'-6" wide by 2'-0" deep by 20' long. Reinforcing to match Section 31/S3.4. The foundation wall construction at line 2 remains as shown in Section 24/S3.3.
D3.30	Drawings S2.1b	Provide wall footing 76/S3.8 under the north wall of the west electrical room in Unit B.
D3.31	Drawings S2.1c and S4.1c	In Unit C provide bearing plate B.P. 7 at both ends of the W8x28 at the north side of the building, at both ends of the W12x35 at the south side of the building, the north end of the W14x22 framing to the foundation wall at the north side of the building, and the east end of the W16x40 bearing on the foundation wall on line 8 (6 locations total). Provide beam bearing pockets in the foundation wall to accommodate bearing plates. Orient the long dimension of the bearing plate perpendicular to the beam.
D3.32	Drawings S2.1c	Provide an additional 18'-6" linear feet of footing 57/S3.7. This is to be located under the masonry wall oriented north-south between lines 5 and 6.
D3.33	Drawings S2.1c	Dimensional clarification: The masonry shear wall located on the south side of room B118 shall be repositioned so that it is located directly below the shear walls on second, third and fourth floors. Adjust the strip footing accordingly and all other associated trades.
D3.34	Drawings S3.3	Revise the top of footing elevation for section 27 from 97'-10" to 95'-10". This is to allow plumbing exiting the building to be located above the footing.
D3.35	Drawings S3.3 & S3.4	Revise the footing shown in sections 27 and 28 to be 8'-4" wide by 1'-8" thick. Revise continuous bars from (7) #5 bars to (8) #6 bars. Provide #5 bars at 12" on center in top of footing. Revise the footing shown in sections 24, 25 and 26 to be 7'-0" wide by 1'-6" thick. Revise continuous bars from (6) #5 bars to (7) #6 bars. Provide #5 bars at 12" on center in top of footing.
D3.36	Drawings S3.5	Revise the footing shown in sections 35, 39 and 41 to match the footing shown size reinforcement shown in section 31/S3.4.
D3.37	Drawings S4.5a, S4.5b, S4.5c	At the four penthouses, provide an additional W8 x 40 hollowcore support beam next to the floor openings at approximately mid-span of the hollowcore. Hollowcore shall bear on bottom flange of W8 x 40 as shown in Section 2/S5.1. W8 x 40 beams shall be connected to HSS 20 x 12 x 3/8 beams.
D3.38	Drawings A12.2c	Room 199M Designation POR3 is incorrect - Delete and Add CPT3. B190A and B190B Designation RES-1 is incorrect - Delete and Add POR-3.
D3.39	Drawings A12.2d	Room B106 - Delete POR3; only CPT4 in this room.
D3.40	Drawings A12.2f	Room B106 - Remove TER-1; only CPT4 in this room.

D3.41	Drawings M5.1, M6.1, M6.3	<p>Refer to sheet M6.3 "FCU Piping Detail", sheet M6.1 Stacked Heating and Cooling Coil details and schedules M5.1.</p> <p>As a clarification: The FCU piping detail on M6.3 applies to the vertical high rise fan coil units exposed in student rooms and in areas such as Study and Lounges. Vertical high capacity fan coils and horizontal fan coils shall be piped (external to the FCU) according to the coil piping details on M6.1 less the "stacked feature" and the requirement for a coil pump.</p>
D3.42	Drawings M5.2	<p>Replace AIR HANDLING UNIT SCHEDULE with Attachment D3.42.</p> <p>Add to AHU GENERAL NOTE "D": ONE GAUGE FOR PREFILTER, ONE FOR FINAL FILTER.</p> <p>Add to ENERGY RECOVERY VENTILATION AIR HANDLING UNIT SCHEDULE with Attachment D3.42.</p> <p>Add to ERU GENERAL NOTES "D": ONE GAUGE FOR PREFILTER, ONE FOR FINAL FILTER.</p> <p>Add ERU GENERAL NOTE "E": SCHEDULED RETURN FAN CFM'S REPRESENT AIRFLOW FROM BUILDING SPACES (CFM-R) AND CFM EXHAUSTED FROM THE UNIT (CFM-E). THE DIFFERENCE REPRESENTS PURGE/SEAL CFM AT THE ENERGY RECOVERY WHEEL.</p> <p>Replace RETURN FAN SCHEDULE with Attachment D3.42.</p>
D3.43	Drawings M5.3	<p>Change VERTICAL HI-RISE FAN COIL UNIT SCHEDULE – UNIT A THIRD FLOOR: FCU-A314 from a Size 03 to a Size 04.</p>
D3.44	Drawings M6.1	<p>"Typical Riser Clamp Detail" - In general, pipe sleeves are not required where the floor is core drilled. Exception: Sleeves are required at the floor penetration in the penthouses.</p>
D3.45	Drawings P2.0a	<p>Add a floor cleanout, CO-1, to the storm line in Corridor A099D near Baths A019C and A017C.</p>
D3.46	Drawings P2.0a	<p>Re-route sanitary as shown on attached drawing D3.P1 (Attachment D3.46) to avoid running below the footing.</p>
D3.47	Drawings P2.0bc	<p>Laundry B006 areas. Re-route sanitary as shown on attached drawing D3.P2 (Attachment D3.47) to avoid footings.</p>
D3.48	Drawings P5.1	<p>Plumbing Fixture Schedule: L-1H and SH fixtures that say "by others" should say "fixture provided by general contractor. P.C to connect." Sinks that say "by others" should say "fixture by owner, installed by P.C."</p>
D3.49	Drawings E5.3	<p>Electrical Fire Alarm Riser Diagram – Both Command Centers will have microphones.</p>

- D3.50 Drawings  
E5.4 Riser Diagram – Add Feeder Number Note #14 to Normal Feed to Fire Pump.
- D3.51 Drawings  
E9.1 Panel Schedule MNSBH-2: Delete breaker for fire pump. Refer to Riser Diagram for fire pump connections.
- Panel Schedule MNSBH-2: Add 60A/3P breaker for SPD. Include SPD with this panel.
- Panel Schedule MNSBH-2: Increase Mains Rating and MCB Rating to 1200A.
- Panel Schedule MNSBH-2: Change breaker size for ATS-EQ to 400A.
- Panel Schedule MNSBL-1: Add 60A/3P breaker for SPD. Include SPD with this panel.
- Panel Schedule MEDBH: Change breaker size for ATS-EQ to 400A.
- D3.52 Drawings  
E9.4 Lighting Control Diagram: Include photocell mounted to exterior of the building. System shall be capable of switching circuits on/off based on state of photocell (light or dark) and/or time of day programming. Final programming to be determined by the owner. Include manufacturer's training with owner of not less than 4 hours. E.C. shall include all wiring and accessories for a complete and operational system.

Respectfully submitted,

MSKTD & ASSOCIATES, INC.



Gary E. Voirol, Architect

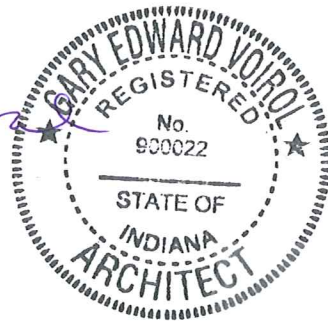

Attachments: D1.056a – D1.056f  
D1.060  
D3.42 (M5.2)  
D3.46 (D3.P1)  
D3.47 (D3.P2)

cc: All plan holders  
File 9.2



26 January, 2012

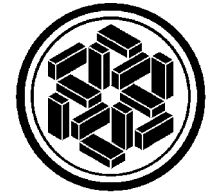
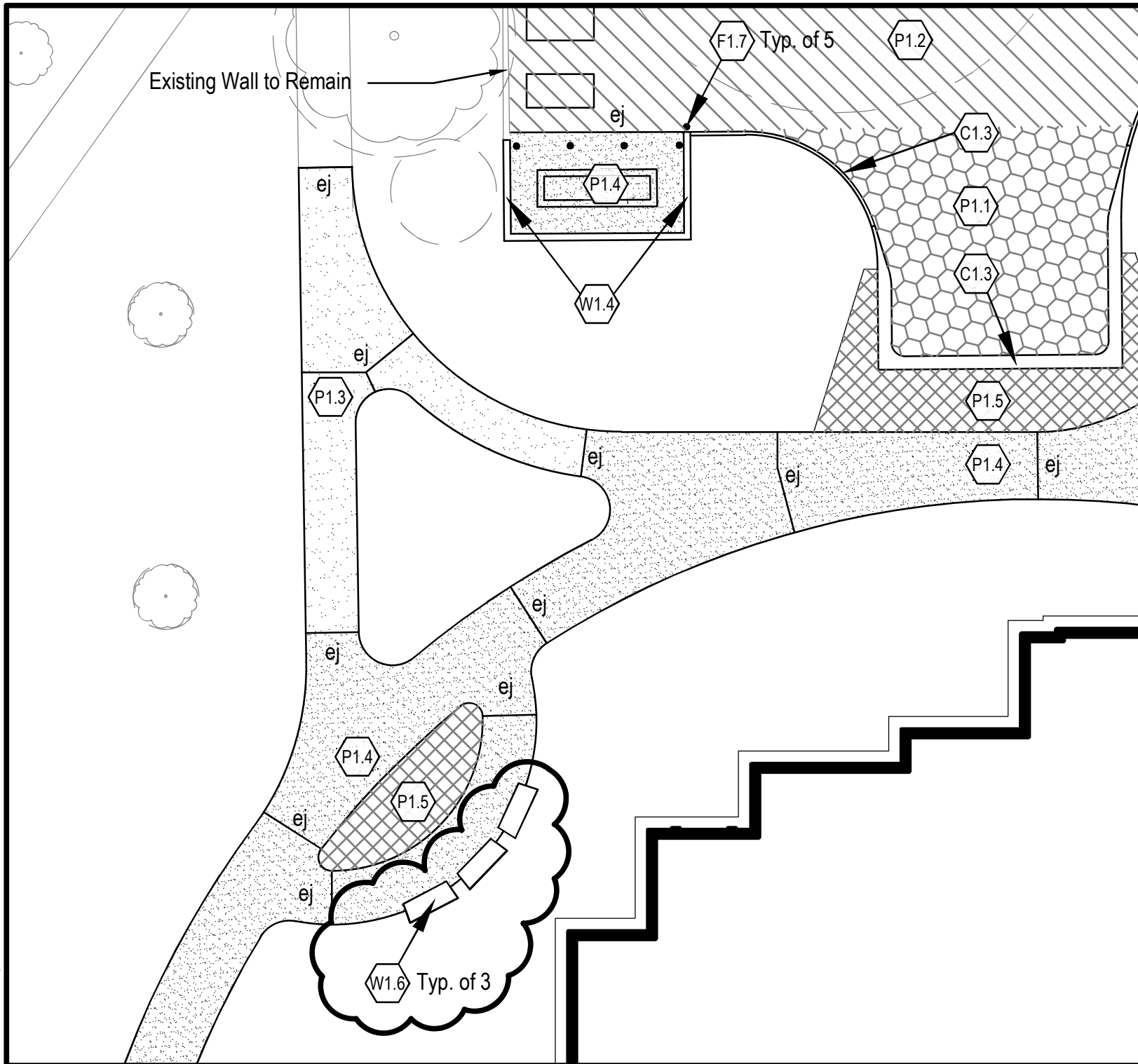

**MSKTD  
& Associates, Inc.**  
ARCHITECTURE • ENGINEERING • INTERIOR DESIGN

1715 MAGNAVOX WAY 930 NORTH MERIDIAN  
FORT WAYNE, IN 46804 INDIANAPOLIS, IN 46204  
voice 260.432.9337 voice 317.917.1190

<http://www.msiktd.com>

**Indiana University**  
**SouthEast Side Residence Hall**  
IU # 20106837  
1801 East Jones Avenue  
Bloomington, Indiana

DATE	1.26.2012
COMMISSION NUMBER	5804
SHEET NUMBER	D1.056b L2.0

26 January, 2012

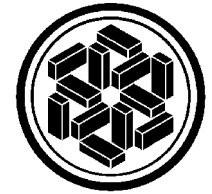
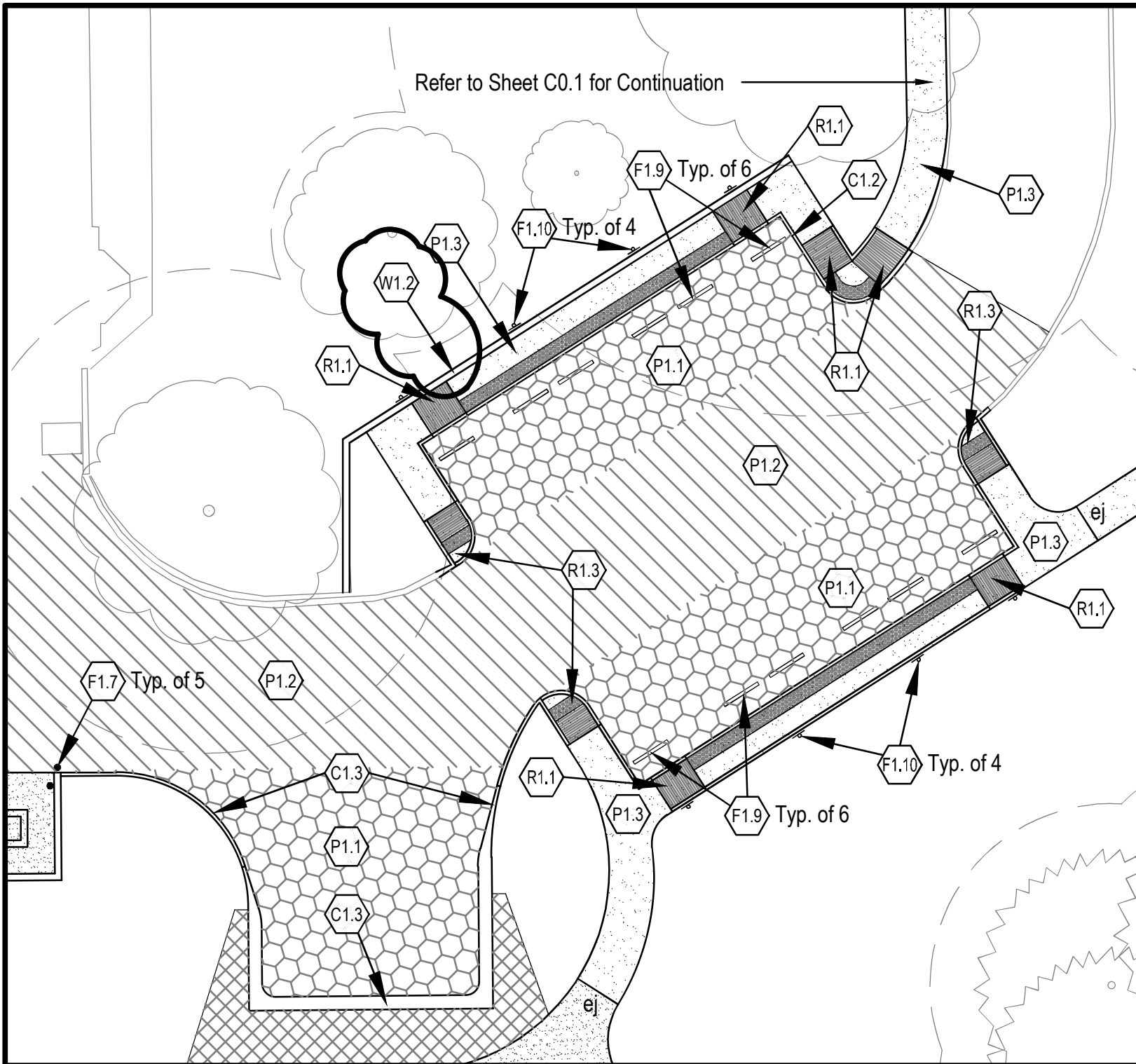

**MSKTD  
& Associates, Inc.**  
ARCHITECTURE • ENGINEERING • INTERIOR DESIGN

1715 MAGNAVOX WAY FORT WAYNE, IN 46804  
930 NORTH MERIDIAN INDIANAPOLIS, IN 46204  
voice 260.432.9337 voice 317.917.1190

<http://www.msktd.com>

**Indiana University  
SouthEast Side Residence Hall**  
IU # 20106837  
1801 East Jones Avenue  
Bloomington, Indiana

DATE	1.26.2012
COMMISSION NUMBER	5804
SHEET NUMBER	D1.056c <b>L2.0</b>

26 January, 2012

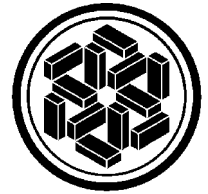
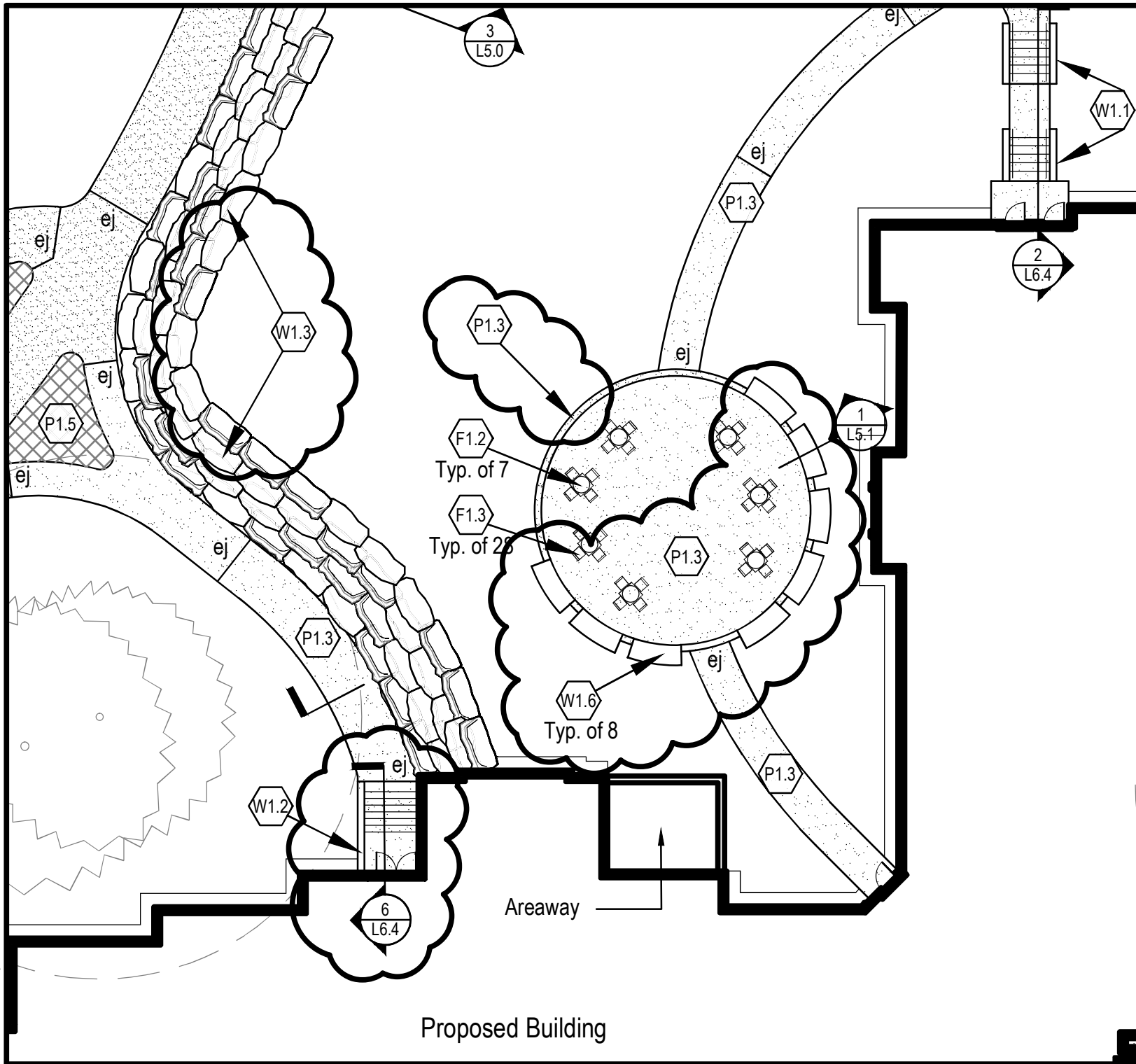

**MSKTD  
& Associates, Inc.**

ARCHITECTURE • ENGINEERING • INTERIOR DESIGN  
 1715 MAGNAVOX WAY FORT WAYNE, IN 46804  
 930 NORTH MERIDIAN INDIANAPOLIS, IN 46204  
 voice 260.432.9337 voice 317.917.1190

<http://www.msiktd.com>

**Indiana University**  
**SouthEast Side Residence Hall**  
 IU # 20106837  
 1801 East Jones Avenue  
 Bloomington, Indiana

DATE	1.26.2012
COMMISSION NUMBER	5804
SHEET NUMBER	D1.056d L2.0

26 January, 2012

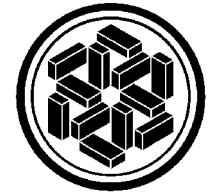
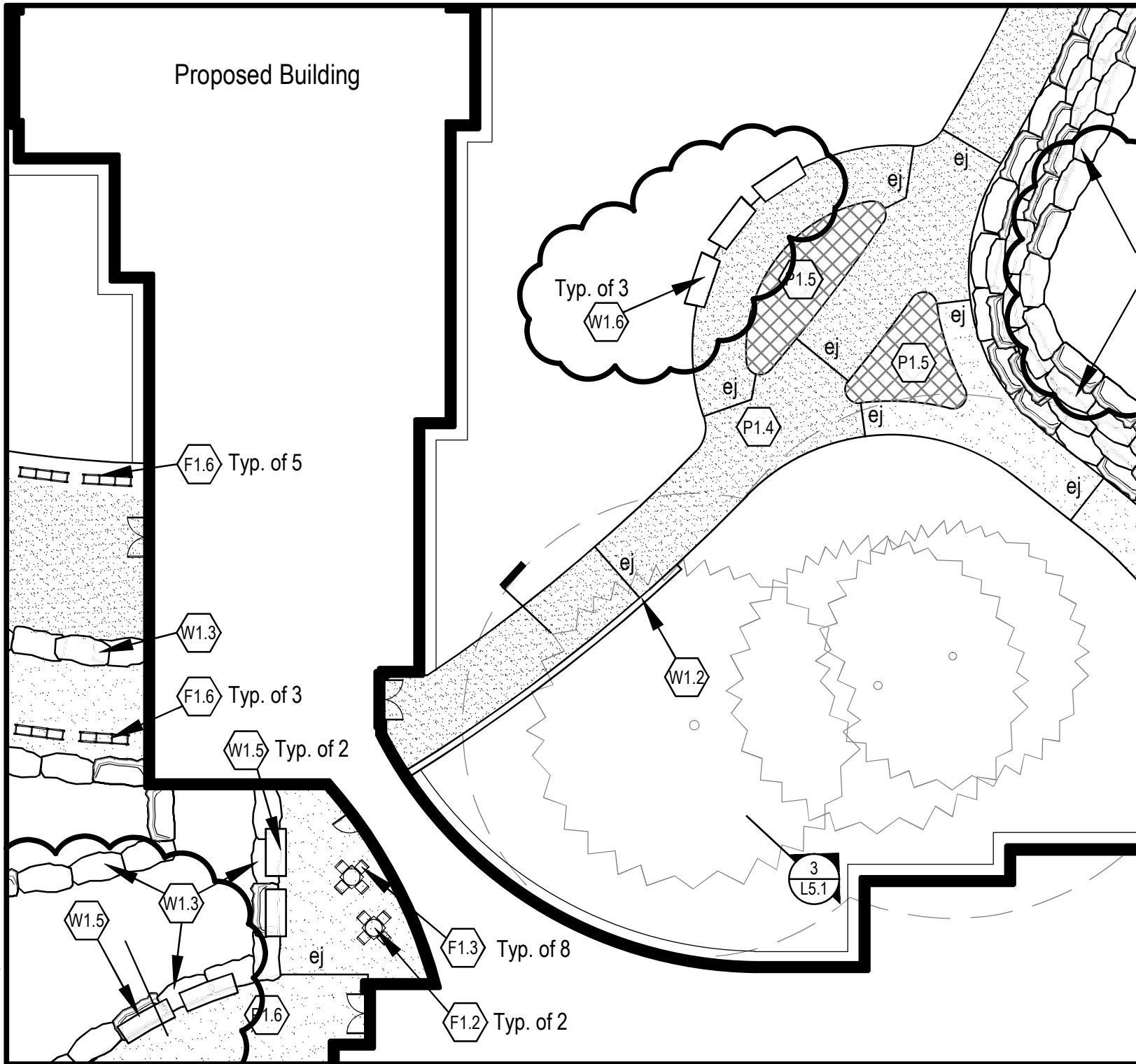

**MSKTD  
& Associates, Inc.**

ARCHITECTURE • ENGINEERING • INTERIOR DESIGN

1715 MAGNAVOX WAY FORT WAYNE, IN 46804  
 930 NORTH MERIDIAN INDIANAPOLIS, IN 46204  
 voice 260.432.9337 voice 317.917.1190

<http://www.msiktd.com>

**Indiana University**  
**SouthEast Side Residence Hall**  
 IU # 20106837  
 1801 East Jones Avenue  
 Bloomington, Indiana

DATE 1.26.2012

COMMISSION NUMBER 5804

SHEET NUMBER D1.056e

**L2.0**

26 January, 2012

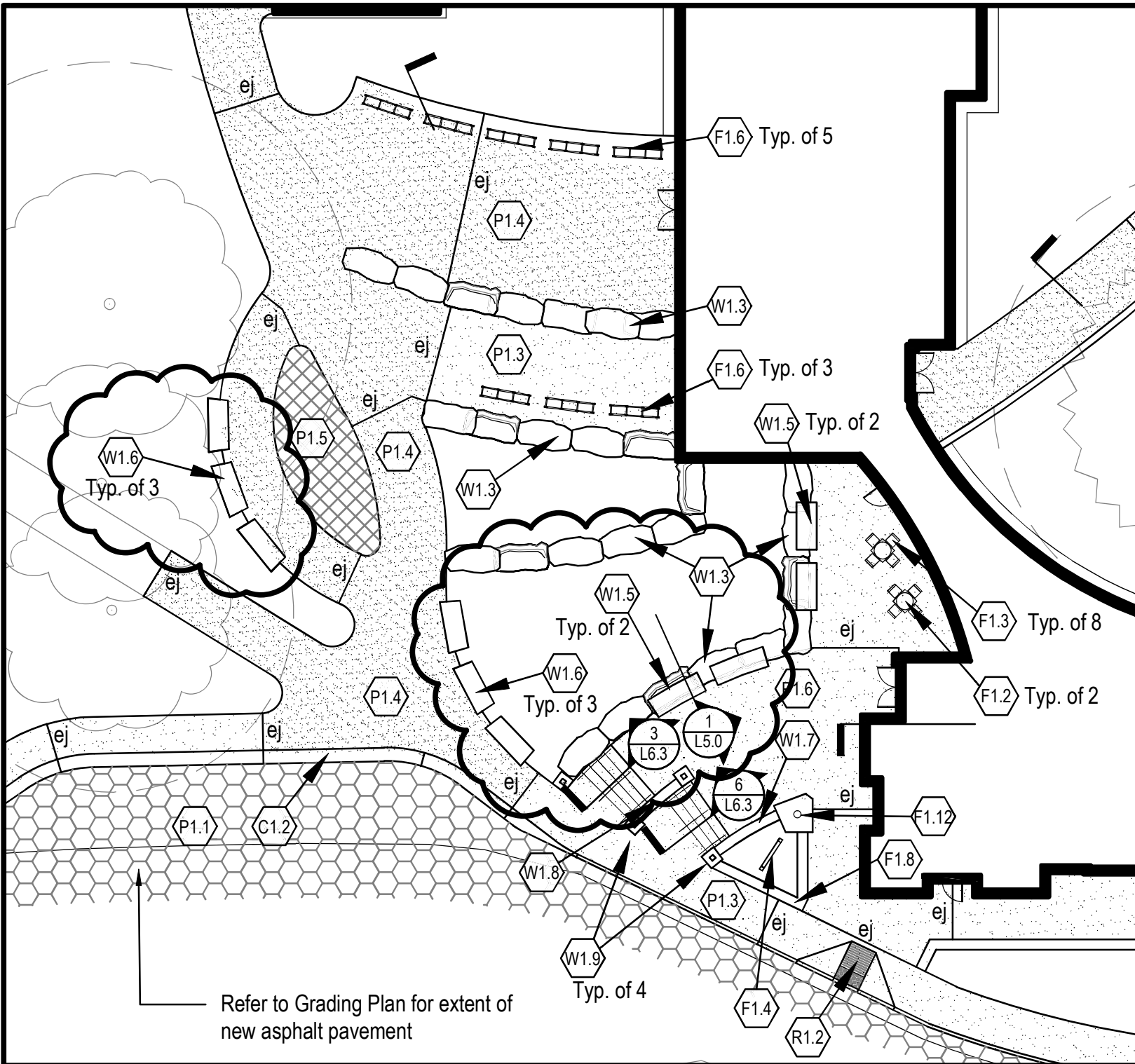

Refer to Grading Plan for extent of new asphalt pavement

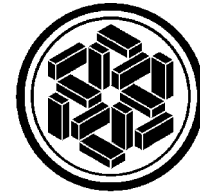

**MSKTD**  
 & Associates, Inc.

ARCHITECTURE • ENGINEERING • INTERIOR DESIGN

1715 MAGNAVOX WAY FORT WAYNE, IN 46804  
 930 NORTH MERIDIAN INDIANAPOLIS, IN 46204  
 voice 260.432.9337 voice 317.917.1190

<http://www.msiktd.com>

**Indiana University**  
**SouthEast Side Residence Hall**  
 IU # 20106837  
 1801 East Jones Avenue  
 Bloomington, Indiana

DATE	1.26.2012
COMMISSION NUMBER	5804
SHEET NUMBER	D1.056f L2.0

1½" O.D. Stainless Steel Pipe, typ. at all stair conditions. See plans for locations. Submit full shop drawings for review by the Landscape Architect.

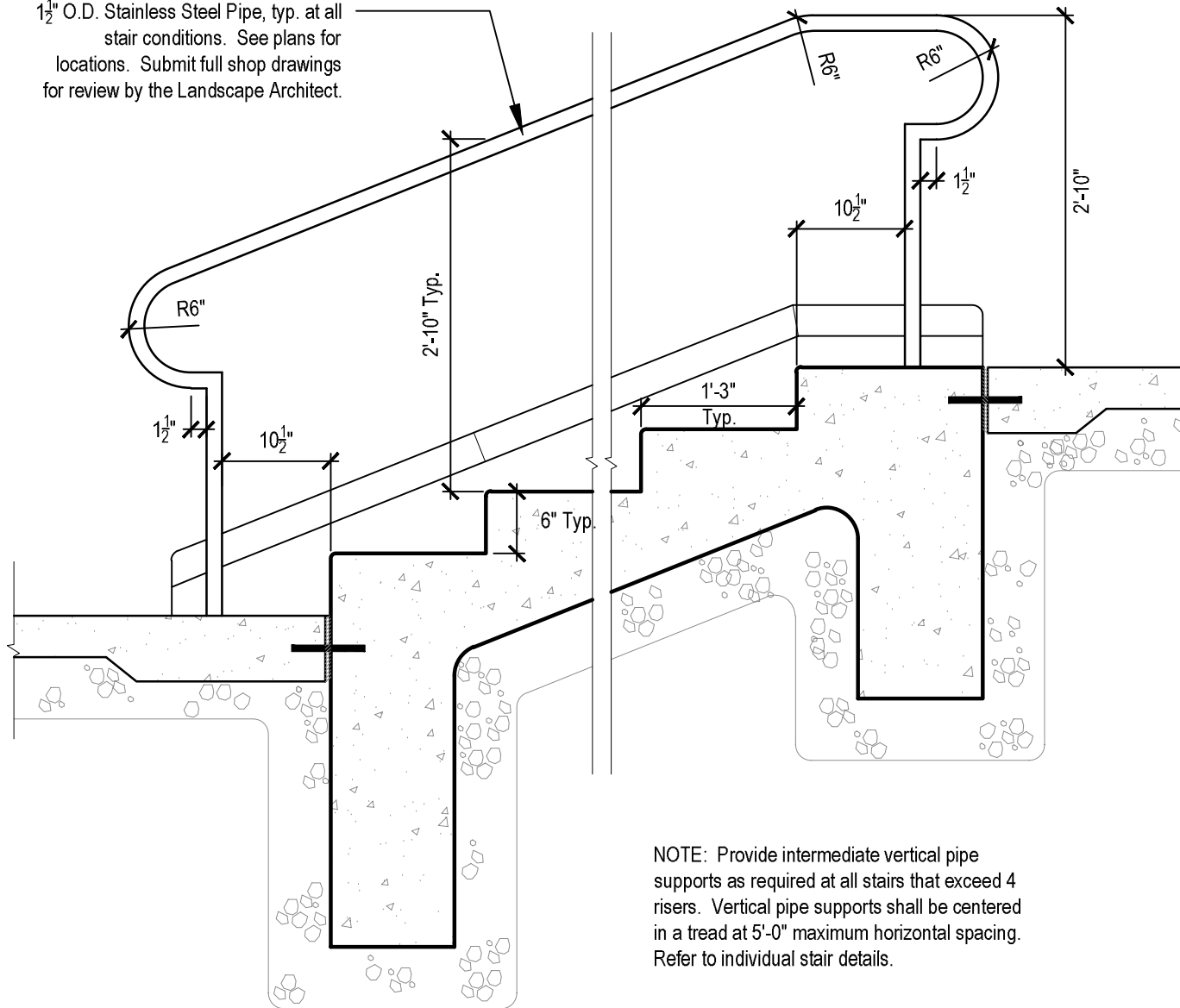

NOTE: Provide intermediate vertical pipe supports as required at all stairs that exceed 4 risers. Vertical pipe supports shall be centered in a tread at 5'-0" maximum horizontal spacing. Refer to individual stair details.

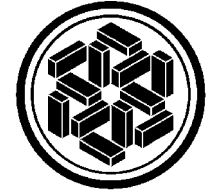

**MSKTD  
& Associates, Inc.**

ARCHITECTURE • ENGINEERING • INTERIOR DESIGN

1715 MAGNAVOX WAY FORT WAYNE, IN 46804  
930 NORTH MERIDIAN INDIANAPOLIS, IN 46204  
voice 260.432.9337 voice 317.917.1190

<http://www.msktd.com>

**Indiana University  
SouthEast Side Residence Hall**  
IU # 20106837  
1801 East Jones Avenue  
Bloomington, Indiana

DATE 1.26.2012

COMMISSION NUMBER 5804

SHEET NUMBER D1.060

**L6.4**

**5**

**TYPICAL STAIR HANDRAIL**

Scale: 3/4" = 1'-0"

1½" O.D. Stainless Steel Pipe, typ. at all stair conditions. See plans for locations. Submit full shop drawings for review by the Landscape Architect.

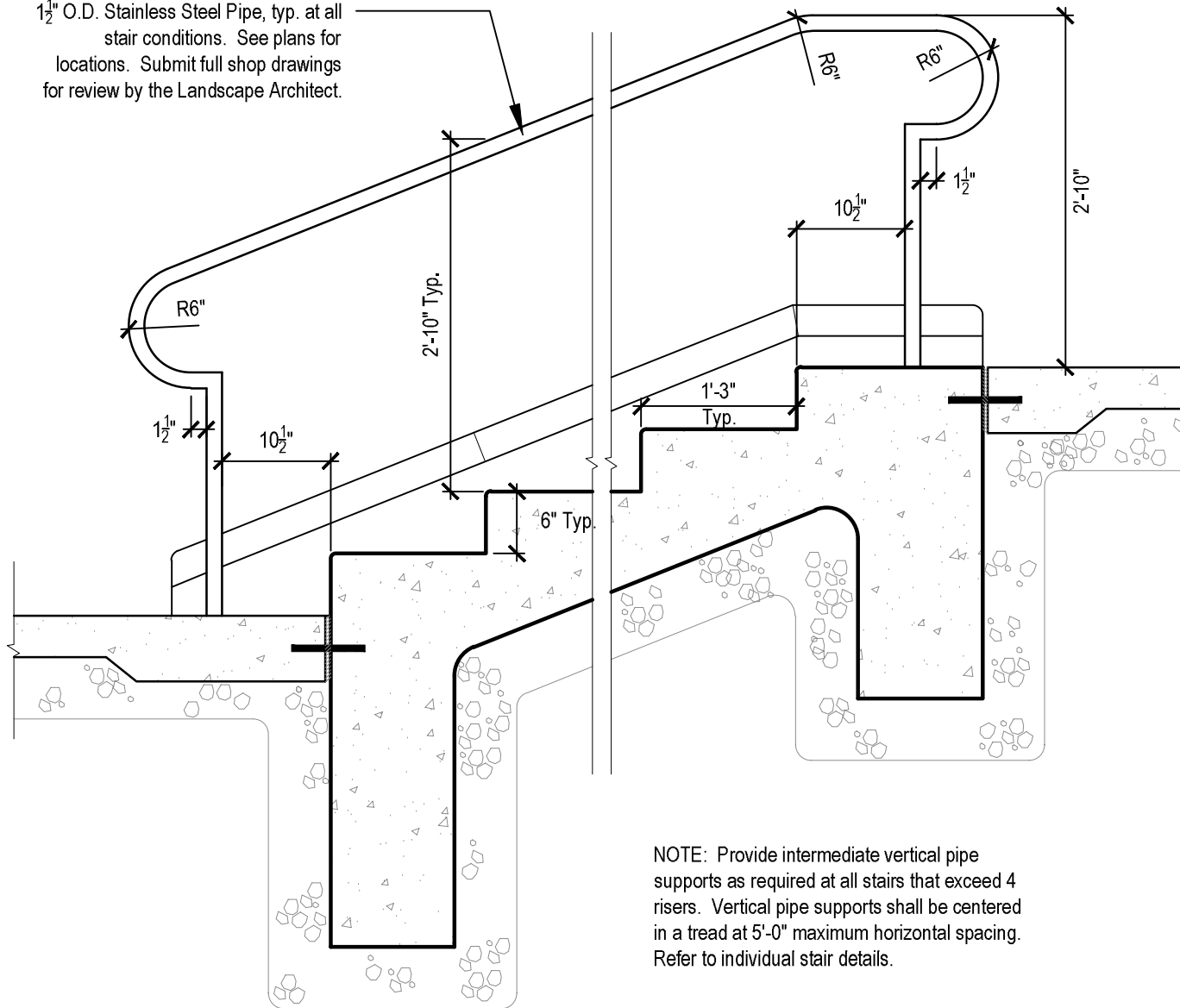

NOTE: Provide intermediate vertical pipe supports as required at all stairs that exceed 4 risers. Vertical pipe supports shall be centered in a tread at 5'-0" maximum horizontal spacing. Refer to individual stair details.

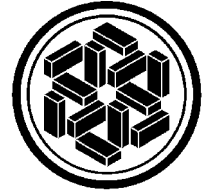

**MSKTD  
& Associates, Inc.**

ARCHITECTURE • ENGINEERING • INTERIOR DESIGN

1715 MAGNAVOX WAY FORT WAYNE, IN 46804  
930 NORTH MERIDIAN INDIANAPOLIS, IN 46204  
voice 260.432.9337 voice 317.917.1190

<http://www.msktd.com>

**Indiana University  
SouthEast Side Residence Hall**  
IU # 20106837  
1801 East Jones Avenue  
Bloomington, Indiana

DATE 1.26.2012

COMMISSION NUMBER 5804

SHEET NUMBER D1.060

**L6.4**

**5**

**TYPICAL STAIR HANDRAIL**

Scale: 3/4" = 1'-0"

2/3/2012 11:39:49 AM

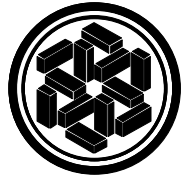

**MSKTD**  
& Associates, Inc.

ARCHITECTURE ENGINEERING INTERIOR DESIGN

1715 MAGNAVOX WAY FORT WAYNE, IN 46804  
voice 260.432.9337

930 NORTH MERIDIAN INDIANAPOLIS, IN 46204  
voice 317.917.1190

http://www.mskskd.com

D3. ENERGY RECOVERY VENTILATION AIR HANDLING UNITS								
TAG	SUPPLY FAN			RETURN FAN				NOTES
	CFM	HP	BHP	CFM-R	CFM-E	HP	BHP	
ERU-4	4125	7.5	4.29	2310	2603	2	1.36	1
ERU-5	5235	7.5	4.85	5355	5795	5	3.59	1
ERU-6	2835	5	2.64	2865	3205	3	1.76	1
ERU-7	3075	5	2.93	1930	2180	1.5	1.17	1
ERU-8	3800	5	3.71	3000	3250	3	1.91	1,2

**ERU GENERAL NOTES (APPLIES TO ALL SELECTIONS, UNLESS NOTED OTHERWISE):**

- A. DISCONNECTS PROVIDED BY E.C.
- B. VFD'S FOR HEAT WHEELS PROVIDED BY MANUFACTURER AND FACTORY INSTALLED.
- C. VFD'S FOR SUPPLY AND RETURN FANS PROVIDED BY SIEMENS, MOUNTED BY M.C., POWR WIRING BY E.C.
- D. PROVIDE MAGNAHELIC PRESSURE GAUGES ACROSS FILTER BANKS. ONE GAUGE FOR PREFILTER, ONE FOR THE FINAL FILTER.
- E. SCHEDULED RETURN FAN CFM'S REPRESENT AIRFLOW FROM BUILDING SPACES (CFM-R) AND CFM EXHAUSTED FROM THE UNIT (CFM-E). THE DIFFERENCE REPRESENTS PURGE/SEAL CFM AT THE ENERGY RECOVERY WHEEL.

**SPECIFIC NOTES:**

- 1. AHU MANUFACTURE SHALL PROVIDE AND INSTALL AIRFLOW MEASURING ON RETURN AND SUPPLY FAN INLET, EBTRON HTA104-F OR EQUIVALENT. SHIP AIRFLOW MONITOR CONTROL PANEL LOOSE, AND CIC CONTRACTOR WILL INSTALL IN THE FIELD. 24V POWER TO THE PANEL TO BE BY SEIMENS.
- 2. THE VOLUME OF ERU-8 WILL VARY BETWEEN 2,600 CFM AND 3,800 CFM IN RESPONSE TO THE SEQUENCE FOR AIR HANDLER AHU-1. SEE THE SEQUENCE OF OPERATION ON SHEET M7.1

AIR HANDLING UNIT SCHEDULE																										
TAG	MFG	SUPPLY FAN							RETURN FAN						CHILLED WATER COIL											NOTES
		Total CFM	ELECTRICAL	RPM	ESP	TSP	HP	BHP	CFM	RPM	ESP	TSP	HP	BHP	EDB	EWB	LDB	EWT	LWT	GPM	COIL #	FINS/ IN	WPD	TOTAL MBH	FPM	
AHU-1	HAAKON	13,250	460/3/60	1731	2.75	5.25	20	15.91	10,640	1227	1.25	1.50	5.00	3.91	71.2	61.8	52.5	42	55	57	8	8	1.99	367.5	497	1,3
AHU-2	HAAKON	2,100	460/3/60	3091	2.5	4.25	3	2.49							80.4	56.4	52	42	55	10	7	8	8.06	64.8	400	2,4
AHU-3	HAAKON	1,570	460/3/60	3432	2.5	4.25	3	1.86							80.4	56.4	52	42	55	7	7	8	3.55	48.4	399	2,4

**AHU GENERAL NOTES (APPLIES TO ALL SELECTIONS, UNLESS NOTED OTHERWISE):**

- A. DISCONNECTS PROVIDED BY E.C.
- B. VFD'S FOR FANS PROVIDED BY SIEMENS, MOUNTED BY M.C., POWER WIRING BY E.C.
- C. 2" MERV 8 PRE-FILTER, 12" MERV 13 FINAL FILTER.
- D. PROVIDE MAGNAHELIC PRESSURE GAUGES ACROSS FILTER BANKS. ONE GAUGE FOR PREFILTER, ONE FOR FINAL FILTER.

**SPECIFIC NOTES:**

- 1. AHU MANUFACTURE SHALL PROVIDE AND INSTALL AIRFLOW MEASURING ON RETURN AND SUPPLY FAN INLET, EBTRON HTA104-F OR EQUIVALENT. SHIP AIRFLOW MONITOR CONTROL PANEL LOOSE, AND CIC CONTRACTOR WILL INSTALL IN THE FIELD. 24V POWER TO THE PANEL TO BE BY SEIMENS.
- 2. AHU MANUFACTURE SHALL PROVIDE AND INSTALL AIRFLOW MEASURING ON SUPPLY FAN INLET, EBTRON HTA104-F OR EQUIVALENT. SHIP AIRFLOW MONITOR CONTROL PANEL LOOSE, AND CIC CONTRACTOR WILL INSTALL IN THE FIELD. 24V POWER TO THE PANEL TO BE BY SIEMENS.
- 3. THE OFFSET BETWEEN THE SUPPLY AND RETURN AIR VOLUME WILL VARY, AS COMMANDED BY THE DEMAND CONTROL VENTILATION SEQUENCE AS SHOWN ON SHEET M7.1
- 4. SEQUENCED WITH SEPARATE RETURN FAN, NOT INTEGRAL TO AHU.

RETURN FAN SCHEDULE												
TAG	MANUFACTURER	MODEL	SIZE	CFM	ESP IN. WC	ELECTRICAL	HP (w)	BHP	MOUNTING STYLE	DRIVE	SERVICE	NOTES
RF-2	COOK	SQI-B	135	2,100	1.75	460/3/60	1-1/2	1.34	INLINE	BELT	AHU-2	1
RF-3	COOK	CPA-A	150	1,570	1.75	460/3/60	3/4	0.65	FLOOR	BELT	AHU-3	2

**RETURN FAN GENERAL NOTES (APPLIES TO ALL SELECTIONS, UNLESS NOTED OTHERWISE):**

- A. DISCONNECTS PROVIDED BY E.C.
- B. VFD'S PROVIDED BY SIEMENS, MOUNTED BY M.C, POWER WIRING BY E.C.
- C. PREMIUM-EFFICIENCY MOTOR RATED FOR INVERTER DUTY

**SPECIFIC NOTES:**

- 1. PROVIDE SPRING ISOLATORS FOR SUSPENDED MOUNTING.
- 2. PROVIDE SPRING ISOLATORS FOR FLOOR MOUNTING.

- REVISION TO SHEET M5.1
- ADDED BHP FOR AHU SUPPLY AND RETURN FANS
  - MODIFIED AHU GENERAL NOTE "D".
  - ADDED BHP FOR ERU SUPPLY AND RETURN FANS
  - ADDED ACTUAL EXHAUST CFM'S (CFM-E) FOR ERU'S.
  - MODIFIED ERU GENERAL NOTE "D".
  - ADDED ERU GENERAL NOTE "E".
  - ADDED BHP TO RETURN FAN SCHEDULE.

Revisions: 3 ADDENDUM 3      Date: 2/03/12      By: EMK

DATE 2/06/12

COMMISSION NUMBER 5804

D3.42

**Indiana University**  
**Rose & Jones Residence Hall**  
 IU # 20106837  
 1801 East Jones Avenue  
 Bloomington, Indiana

2/2/2012 3:22:06 PM

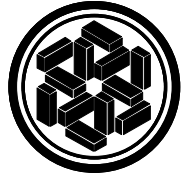
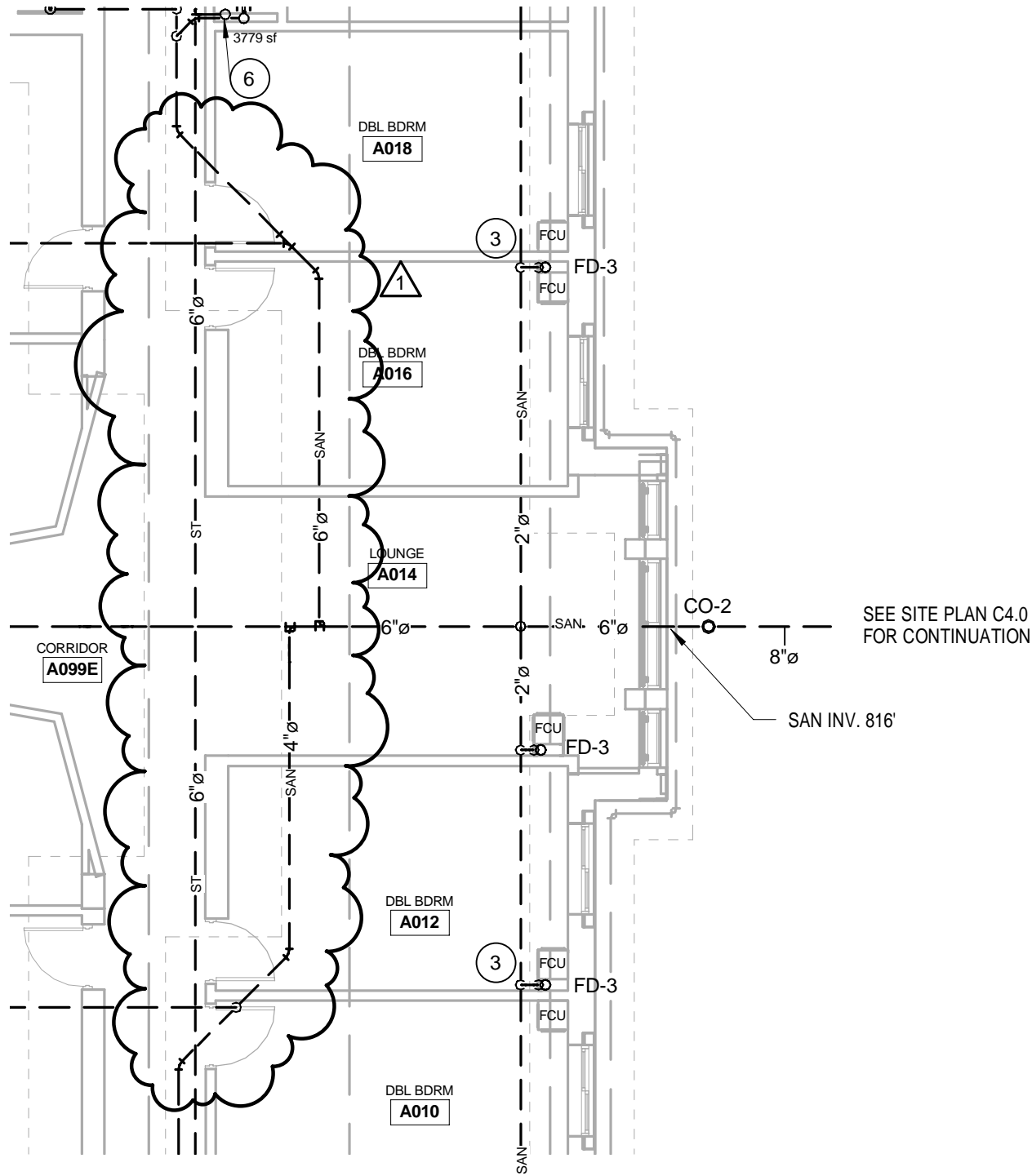

**MSKTD**  
& Associates, Inc.

ARCHITECTURE ENGINEERING INTERIOR DESIGN

1715 MAGNAVOX WAY 930 NORTH MERIDIAN  
FORT WAYNE, IN 46804 INDIANAPOLIS, IN 46204  
voice 260.432.9337 voice 317.917.1190

<http://www.msktd.com>

**Indiana University**  
**SouthEast Side Residence Hall**  
IU # 20106837  
1801 East Jones Avenue  
Bloomington, Indiana

DATE 2/02/2012

COMMISSION NUMBER 5804

SHEET NUMBER D3.46

**D3.P1**

2/2/2012 3:22:07 PM

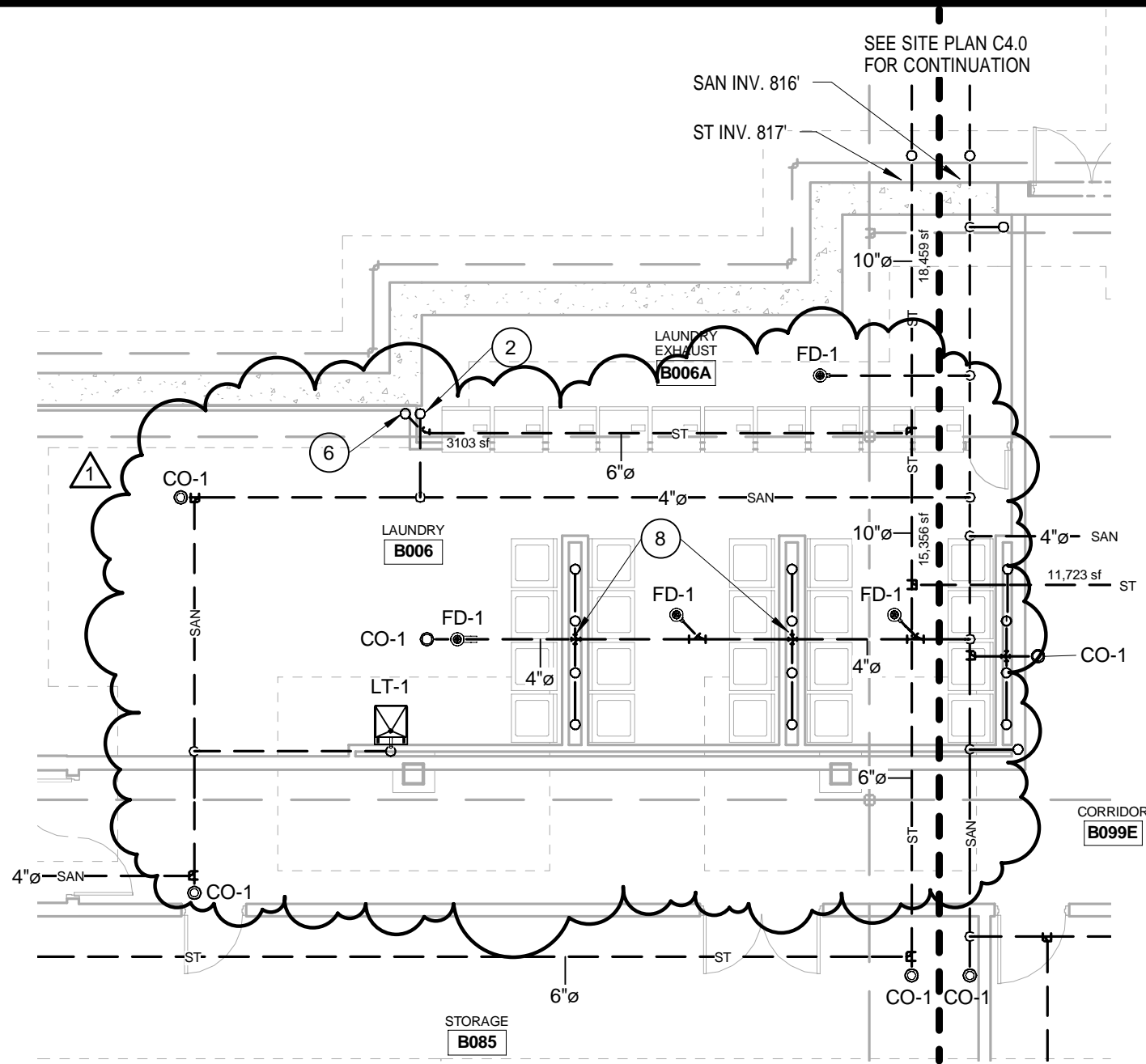

SEE SITE PLAN C4.0  
FOR CONTINUATION

SAN INV. 816'

ST INV. 817'

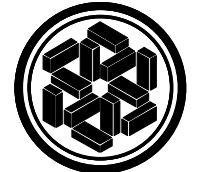

**MSKTD**  
& Associates, Inc.

ARCHITECTURE ENGINEERING INTERIOR DESIGN

1715 MAGNAVOX WAY FORT WAYNE, IN 46804  
930 NORTH MERIDIAN INDIANAPOLIS, IN 46204  
voice 260.432.9337 voice 317.917.1190

<http://www.msktd.com>

**Indiana University**  
**SouthEast Side Residence Hall**  
IU # 20106837  
1801 East Jones Avenue  
Bloomington, Indiana

# Underground Ground Floor

1/8" = 1'-0"

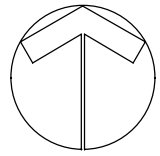

DATE	2/02/2012
COMMISSION NUMBER	5804
SHEET NUMBER	D3.47
<b>D3.P2</b>	